

**QUARTERLY MONITORING REPORT
Springfield Street School Complex
Providence, Rhode Island**

**Project No. 081-12152-02
February 2006 Monitoring Round**

Prepared for
Providence School Department
797 Westminister Street
Providence, RI 02903

Prepared by
LFR Inc.
300 Metro Center Boulevard
Suite 250
Warwick, RI 02886
www.lfr.com



February 17, 2005

081-12152-02

Mr. Jeffrey Crawford
Rhode Island Department of Environmental Management
Office of Waste Management
235 Promenade Street
Providence, RI 02908-5767

Subject: Quarterly Monitoring for Springfield Street School Complex, 50 Springfield Street, Providence, RI – February 2006 Monitoring Round

Dear Mr. Crawford:

Quarterly monitoring was conducted on February 1, 2 and 3, 2006 at the above referenced site. The monitoring was performed in accordance with the *Long-Term Operation and Maintenance Plan and Site Contingency Plan (O&M Plan)* contained in the *Remedial Action Work Plan* prepared by ATC dated April 2, 1999, revised May 3, 1999 and May 9, 1999. The *Remedial Action Work Plan (RAWP)* was approved by the Rhode Island Department of Environmental Management (RIDEM) in a letter dated June 4, 1999.

Results of monitoring are provided in the following sections and in the attachments.

COVER MONITORING

LFR conducted a visual survey of the site for evidence of significant soil cover erosion, or for any areas where the orange snow fencing indicator barrier was visible. LFR did not observe any areas where the orange indicator barrier was visible during this monitoring event. We identified a few minor areas of damage to the grass due to plowing, vehicles driving on wet grass, or damage by winter weather. These areas will be repaired along with other areas of concern discussed in our letter to RIDEM dated February 10, 2006.

SUB-SLAB VENTILATION SYSTEM

The sub-slab ventilation system was inspected by LFR during the quarterly monitoring on February 2, 2006. All systems were operating upon arrival for the monitoring events.

Influent and effluent air from the two blowers at the elementary school and the two blowers at the middle school was monitored. Samples of influent and effluent gas were collected at each location and screened for methane, carbon dioxide, carbon monoxide, hydrogen sulfide, and volatile organic compounds (VOC). Results are provided in Table 1.

Methane, carbon monoxide, carbon dioxide and hydrogen sulfide concentrations in the subslab ventilation system samples were all measured as zero during this monitoring event. PID readings at the elementary school ranged from 0.0 to 0.2 ppm. PID readings at the middle school ranged from 0.0 to 0.1 ppm. None of the PID readings exceeded the Remedial Action Work Plan Action Level of 5 ppm.

INDOOR AIR MONITORING

Indoor air monitoring was conducted on using a Landtec Gem 2000 landfill gas monitor and a Mini Rae photoionization detector. Results of monitoring are provided in the Table 2. No parameters were detected at concentrations above the action levels specified in the Remedial Action Work Plan during the indoor air monitoring.

The methane monitors at the middle school and the elementary schools had stickers that indicated they were last calibrated by Diamond Calibration personnel on January 5, 2006. The sensors appeared to be functioning. Readings ranged from 0 to 6% LEL (lower explosive limit). Calibration Certificates from Diamond Calibration indicate that many of the sensors read above 0 when calibrated to the zero gas. This prevents the sensors from giving a fault alarm if the reading drops below zero due to a sudden temperature change, and still provides a conservative measure of protection because the alarm limit is still 10% LEL.

GROUNDWATER MONITORING

Five groundwater monitoring wells were sampled by LFR on February 2, 2006. Prior to sampling, the depth to water was gauged, and a volume of water equivalent to approximately three well volumes was removed from each well. Temperature, specific conductance, dissolved oxygen, and pH were measured in the field prior to sampling. Depth to groundwater ranged between 10.46 and 16.04 feet below the ground surface. Groundwater samples were collected in laboratory prepared sample jars and delivered under chain-of-custody protocol to Contest Laboratory in East Longmeadow, Massachusetts for analysis for volatile organic compounds by EPA method 8260. The laboratory report is provided as Attachment A. Results of analysis of groundwater samples are summarized in Table 3.

Two compounds, trichloroethylene and 1,1,2-trichloroethane, were detected in the sample from ATC-1 at concentrations of 1.3 and 1.2 $\mu\text{g}/\text{L}$. The concentration of trichloroethylene is well below the GB groundwater standard of 540 $\mu\text{g}/\text{L}$. There is no published RIDEM GB groundwater standard for 1,1,2-trichloroethane. Toluene was detected at 3.0 $\mu\text{g}/\text{L}$ in the sample from monitoring well ATC-3, which is well below the GB groundwater standard of 1,700 $\mu\text{g}/\text{L}$.

SOIL GAS MONITORING

Soil gas monitoring was conducted at 29 locations on February 1 and 3, 2006. The sampling was conducted by placing an air sampling gripper cap on each well and attaching

SOIL GAS MONITORING

Soil gas monitoring was conducted at 29 locations on February 1 and 3, 2006. The sampling was conducted by placing an air sampling gripper cap on each well and attaching a piece of tubing. A volume of air equivalent to approximately 3 well volumes was removed from each well using an SKC Airchek Sampling pump. Soil gas was then screened using a Landtec Gem 2000 Landfill Gas Analyzer & Extraction Monitor and a MiniRae Photoionization Detector (PID).

Air samples were also collected in new laboratory supplied Tedlar bags using the SKC Airchek Pump from wells WB-2 and MPL-6. The Tedlar bags were submitted to Con-test Analytical Laboratory for analysis for VOC via EPA method TO-14.

Soil Gas Field Monitoring Results

Soil gas samples were screened for methane, carbon monoxide, hydrogen sulfide, carbon dioxide, oxygen, and total VOCs. Soil gas survey results are provided in Table 4.

Methane readings were 0% methane (non-detect) at all locations during the monitoring event, except WB-8, where a reading of 0.1% was obtained. Carbon dioxide (0.0%) and oxygen (21.4%) concentrations at this location were similar to ambient air. Since conditions are aerobic at this location and in surrounding wells, there is no indication of methane generation at this location. The measured concentration was below the RAWP Action Level of 0.5%.

Carbon monoxide and hydrogen sulfide were not detected at any of the monitoring locations.

One PID reading above 0 was detected, a reading of 0.5 at location EPL-2. EPL-2 is located adjacent to the elementary school parking lot. The concentration is below the RAWP Action Level of 5 ppm.

Carbon dioxide was detected at 17 locations with detectable concentrations ranging from 0.1% to 12.6% during the February 1 and 3, 2006 monitoring event. The carbon dioxide Remedial Action Work Plan Action Level is 0.1%, and 14 readings exceeded the action level. The presence of carbon dioxide in soil gas is an indicator of subsurface bacterial activity and does not represent a threat to users of the property. Graphs presenting carbon dioxide, oxygen, and methane concentrations over time for seven representative wells are presented in Attachment B. Concentrations detected during this round of monitoring appear to be consistent with the patterns of rising carbon dioxide concentrations in the summer and fall, and falling carbon dioxide concentrations in the winter and spring. The number of locations with carbon dioxide over the Action Level is less than the last quarter, and the maximum concentration of carbon dioxide detected is lower than the last quarter.

Soil Gas Laboratory Results

In accordance with the O&M Plan, two soil gas samples were collected in Tedlar bags and submitted to Con-Test Analytical Laboratories for analysis by method TO-14. Results of the analysis are summarized in Table 5, and the laboratory report is provided in Attachment C. Several compounds were detected at low concentrations. The results were typical of the concentrations and compounds which have been detected in previous monitoring events.

The Occupational Safety and Health Administration (OSHA) Permissible Exposure Limits (PELs) are provided in Table 5 for comparison purposes even though they are not applicable to soil gas, because it does not represent exposure point concentrations. The PELs are the average concentrations that OSHA allows to be present in a workplace without any respiratory protection or exposure controls. The concentrations detected in soil gas were well below the OSHA PELs.

CONCLUSIONS

Methane, carbon monoxide, hydrogen sulfide and organic vapor concentrations did not exceed action levels in any soil gas samples, indoor air or subslab ventilation system samples. Carbon dioxide concentrations in soil gas exceeded the action level at some locations. This condition is typical of what has been detected during previous monitoring events and appears to be a result of seasonal naturally occurring bacterial activity in the subsurface.

Inspection of the cap did not reveal any evidence of exposure of the orange barrier or of breaches of the cap that would allow users of the Site to be exposed to the capped soils. However, some areas are in need of reseeding and regrading, and the storm drain in the courtyard of the middle school is in need of repairs. As noted in separate correspondence, these areas will be repaired.

If you have any questions or require any additional information, please contact the undersigned at 401-738-3887.

Sincerely,



Donna Holden Pallister, P.E.
Senior Engineer

cc: A. Sepe, City of Providence
R. Troiano, PPBA
J. Boffa, Providence School Department
S. Tremblay, Providence School Department

TABLES

Table 1
System Monitoring Notes
Springfield Street School Complex
Providence, Rhode Island
February 2, 2006

Monitoring Location	Methane % by volume Landtec	Carbon Dioxide % by volume	Oxygen % by volume	Carbon Monoxide PPM	Hydrogen Sulfide PPM	Organic Vapors PPM
Elementary School inlet 1	0.0	0.0	20.8	0	0	0.0
Elementary School inlet 2	0.0	0.0	21.1	0	0	0.0
Elementary School Outlet	0.0	0.0	21.0	0	0	0.2
Middle school front shed inlet	0.0	0.0	21.0	0	0	0.0
Middle school front shed after 2 nd carbon	0.0	0.0	20.9	0	0	0.1
Middle school back shed inlet	0.0	0.0	21.2	0	0	0.0
Middle school back shed after 2 nd carbon	0.0	0.0	21.0	0	0	0.0
Remedial Action Work Plan Action Levels	0.5	1,000 ppm (0.1%)	NA	9 ppm	10 ppm	5 ppm

Measurements made with: GEM 2000 Gas Analyzer & Extraction Monitor, MiniRae PID Meter

Sampling date: February 2, 2006

Measured by: D. Pallister

Table 2
Indoor Air Monitoring Results
Springfield Street School Complex
Providence, Rhode Island
February 2, 2006

Monitoring Location	Methane % by volume	Carbon Dioxide % by volume	Oxygen % by volume	Carbon Monoxide PPM	Hydrogen Sulfide PPM	Organic Vapors PPM
E.S. Front office	0.0	0.0	21.1	0	0	0.0
E.S. Elevator Room	0.0	0.0	21.1	0	0	0.0
E.S. Electrical closet	0.0	0.0	21.2	0	0	0.0
E.S. Gym storage closet	0.0	0.0	20.5	0	0	0.0
E.S. Room 204	0.0	0.0	20.7	0	0	0.0
E.S. Library	0.0	0.0	20.6	0	0	0.2
E.S. Room 106	0.0	0.0	20.6	0	0	0.2
E.S. Stairway Stair B	0.0	0.0	20.7	0	0	0.1
E.S. Room 108	0.0	0.0	20.7	0	0	0.2
E.S. Cafeteria	0.0	0.0	20.7	0	0	1.6
E.S. Elevator	0.0	0.0	21.2	0	0	0.0

Table 2
Indoor Air Monitoring Notes
Springfield Street School Complex
February 2, 2006

Monitoring Location	Methane % by volume	Carbon Dioxide % by volume	Oxygen % by volume	Carbon Monoxide PPM	Hydrogen Sulfide PPM	Organic Vapors PPM
M.S. Front Office	0.0	0.0	20.9	0	0	1.7
M.S. Library	0.0	0.0	20.9	0	0	0.0
M.S. Stairway toward Hartford Ave. (Sensor here)	0.0	0.0	20.9	0	0	0.0
M.S. Crack near door to outside near gym	0.0	0.0	20.9	0	0	0.0
M.S. Former Music Room	0.0	0.0	20.9	0	0	0.2
M.S. Near Sensor Auditorium/ Cafeteria	0.0	0.0	20.9	0	0	0.0
M.S. Hall outside cafeteria next to Sensor	0.0	0.0	20.9	0	0	0.0
M.S. Custodian Office	0.0	0.0	20.8	0	0	0.0

Table 2
Indoor Air Monitoring Notes
Springfield Street School Complex
February 2, 2006

Monitoring Location	Methane % by volume	Carbon Dioxide % by volume	Oxygen % by volume	Carbon Monoxide PPM	Hydrogen Sulfide PPM	Organic Vapors PPM
M.S. Faculty Work Room	0.0	0.0	20.9	0	0	0.0
M.S. Elevator	0.0	0.0	20.9	0	0	0.0
M.S. Elevator Closet	0.0	0.0	20.9	0	0	0.0
M.S. Custodian Closet	0.0	0.0	20.9	0	0	0.3
Remedial Action Work Plan Action Levels	0.5	1,000 ppm (0.1%)	NA	9 ppm	10 ppm	5 ppm

Notes:

E.S. indicates Elementary School

M.S. indicates Middle School

Measurements made with: GEM 2000 Gas Analyzer & Extraction Monitor, MiniRae PID Meter

Table 3
 Summary of Ground Water Sampling Results
 Springfield Street School Complex
 Springfield Street
 Providence, Rhode Island

Monitoring Wells	Compounds	Sampling Dates and Results in µg/L															RIDEM GB Objective		
		2/28/2001	7/20/2001	*9-12/2001	8/1/2002	8/28/2002	12/19/2002	3/18/2003	7/17/2003	11/5/2003	1/22/2004	5/21/2004	8/17/2004	12/2/2004	4/6/2005	7/27/2005		10/27/2005	2/2/2006
ATC-1	Benzene	6.1	ND	18.9	0.9	ND	ND	ND	ND	ND	ND	ND	ND	ND	ND	ND	ND	ND	140
	n-butylbenzene	1.7	ND	2.8	ND	ND	ND	ND	ND	ND	ND	ND	ND	ND	ND	ND	ND	ND	NA
	sec-Butylbenzene	1.1	ND	4.1	ND	ND	ND	ND	ND	ND	ND	ND	ND	ND	ND	ND	ND	ND	NA
	Ethylbenzene	4.5	ND	12.6	ND	ND	ND	ND	ND	ND	ND	ND	ND	ND	ND	ND	ND	ND	1600
	Isopropylbenzene	ND	ND	1.8	ND	ND	ND	ND	ND	ND	ND	ND	ND	ND	ND	ND	ND	ND	NA
	n-Propylbenzene	ND	ND	5.0	ND	ND	ND	ND	ND	ND	ND	ND	ND	ND	ND	ND	ND	ND	NA
	MTBE	12.4	7.0	28.6	ND	ND	ND	ND	ND	ND	ND	ND	ND	ND	ND	ND	ND	ND	5000
	Trichloroethylene	ND	ND	ND	ND	ND	ND	ND	1.27	ND	ND	ND	ND	ND	1.10	ND	ND	1.3	540
	Toluene	2.5	ND	8.2	ND	ND	ND	ND	ND	ND	ND	ND	ND	ND	ND	ND	ND	ND	1700
	1,2,4-Trimethylbenzene	2.2	ND	8.2	ND	ND	ND	ND	ND	ND	ND	ND	ND	ND	ND	ND	ND	ND	NA
ATC-2	1,3,5-Trimethylbenzene	3.4	ND	5.2	ND	ND	ND	ND	ND	ND	ND	ND	ND	ND	ND	ND	ND	ND	NA
	Xylenes	14.6	ND	37	ND	ND	ND	ND	ND	ND	ND	ND	ND	ND	ND	ND	ND	ND	NA
	1,1,2-Trichloroethane	ND	ND	ND	ND	ND	ND	ND	ND	ND	ND	ND	ND	ND	ND	ND	ND	1.2	NA
ATC-3	Chloroform	0.9	ND	ND	1.0	ND	ND	ND	NS	1.1	1.0	1.0	ND	ND	ND	ND	ND	ND	NA
	Toluene	ND	ND	ND	ND	NS	ND	ND	ND	3.03	ND	ND	ND	ND	ND	ND	ND	3.0	1700
ATC-4	Benzene	ND	ND	2.5	0.6	ND	ND	ND	ND	ND	ND	ND	ND	0.5	ND	ND	ND	ND	140
	Chlorobenzene	2.6	ND	57.3	2.7	5.18	ND	ND	ND	ND	ND	ND	ND	0.60	ND	ND	ND	70	
	1,4-dichlorobenzene	4.2	ND	9.2	3.4	3.36	ND	ND	ND	ND	0.80	1.6	2.1	ND	ND	ND	ND	NA	
	MTBE	ND	ND	ND	ND	ND	ND	ND	1.19	9.55	1.06	0.6	0.6	ND	ND	ND	ND	5000	
	1,2,4-Trimethylbenzene	ND	ND	1.7	ND	ND	ND	ND	ND	ND	ND	ND	ND	ND	ND	ND	ND	ND	NA
ATC-5	MTBE	ND	ND	2.2	NS	ND	ND	ND	NS	ND	ND	ND	ND	ND	ND	ND	ND	ND	5000
	Chloroform	ND	ND	ND	ND	ND	ND	ND	NS	ND	ND	0.6	0.6	ND	ND	ND	ND	NA	
Sampled By:	ATC	ATC	ATC	ATC	LFR	LFR	LFR	LFR	LFR	LFR	LFR	LFR	LFR	LFR	LFR	LFR	LFR	LFR	

*ATC Monitoring Report for September through December 2001 did not list date samples were collected.
 ND = not detected above method detection limit
 NS = not sampled
 NA = No applicable standard published
 MTBE is Methyl tert-Butyl Ether
 µg/L = micrograms per liter

Table 4
Soil Gas Survey Results
Springfield Street School Complex
Providence, Rhode Island
February 1 & 3, 2006

Monitoring Well	Methane % by volume	Carbon Dioxide % by volume	Oxygen % by volume	Carbon Monoxide PPM	Hydrogen Sulfide PPM	Organic Vapors PPM
WB-1	0.0	0.0	21.4	0	0	0
WB-2	0.0	0.1	21.4	0	0	0
WB-3	0.0	0.0	21.8	0	0	0
WB-4	0.0	0.0	22.0	0	0	0
WB-5	0.0	0.0	21.5	0	0	0
WB-6	0.0	0.0	21.5	0	0	0
WB-7	0.0	0.0	21.5	0	0	0
WB-8	0.1	0.0	21.4	0	0	0
WB-12	0.0	0.0	21.3	0	0	0
WB-13	0.0	0.0	21.4	0	0	0
WB-14	0.0	0.1	21.1	0	0	0
WB-15	0.0	0.3	20.8	0	0	0
EPL-1	0.0	0.0	21.7	0	0	0
EPL-2	0.0	0.2	21.2	0	0	0.5
EPL-3	0.0	0.0	21.7	0	0	0
EPL-4	0.0	0.8	19.6	0	0	0
EPL-5	0.0	1.8	18.6	0	0	0
ENE-1	0.0	0.1	20.3	0	0	0
MG1	0.0	0.8	19.8	0	0	0
MG2	0.0	2.1	20.2	0	0	0
MG3	0.0	0.5	21.1	0	0	0
MG4	0.0	0.0	21.3	0	0	0
MPL5	0.0	12.6	8.3	0	0	0
MPL2	0.0	1.2	21.2	0	0	0
MPL3	0.0	11.6	7.4	0	0	0

Monitoring Well	Methane % by volume	Carbon Dioxide % by volume	Oxygen % by volume	Carbon Monoxide PPM	Hydrogen Sulfide PPM	Organic Vapors PPM
MPL8	0.0	2.3	19.3	0	0	0
MPL6	0.0	4.0	8.2	0	0	0
MPL7	0.0	4.4	13.1	0	0	0
MG5	0.0	0.9	20.4	0	0	0
Remedial Action Work Plan Action Levels	0.5%	1,000 PPM (0.1%)	NA	9 PPM	10 PPM	5 PPM

Notes:

Sampled by: A. Lang (2/1/06) and J. Bonn (2/3/06)

Weather Conditions: sunny, windy, ~40°F (2/1/06); rain, windy ~55 °F (2/3/06)

Sampling Equipment: GEM 2000 Gas Analyzer & Extraction Monitor, MiniRae PID Meter

PPM = parts per million

Table 5
Soil Gas Laboratory Analysis Results
Springfield Street School Complex
February 3, 2006

Parameter	OSHA PELs (PPBv)	Results of Analysis in parts per billion by volume (PPBv)	
		MPL-6	WB-2
1,1,2-Trichloro-1,2,2-Trifluoroethane	1,000,000	<0.5	<0.5
1,4-Dichlorobenzene	75,000	0.7	0.8
Chloromethane	100,000	<0.5	<0.5
Dichlorodifluoromethane	1,000,000	<0.5	<0.5
Ethylbenzene	100,000	1.0	0.9
Methylene Chloride	100,000	<0.5	1.0
Styrene	100,000	0.7	0.9
Toluene	200,000	9.2	8.7
M/p-Xylene	100,000	3.3	3.0
o-Xylene	100,000	1.3	1.2

Table lists only detected compounds. See laboratory report for full list of analytes.

Occupational Safety and Health Administration (OSHA) PELs = Permissible Exposure Limits
from NIOSH Pocket Guide to Chemical Hazards

FIGURE

NOTES:

THE FOLLOWING MAP IS REFERENCED: ELEMENTARY & MIDDLE SCHOOLS, PROVIDENCE RHODE ISLAND, ISSUED FOR, CITY OF PROVIDENCE, GRADING AND SAMPLING LOCATION PLAN, PREPARED BY NORTHEAST ENGINEERS & CONSULTANTS, INC., DATED MAY 19, 1999, SCALE: 1"=50'.

THIS MAP HAS BEEN DIGITIZED FROM THE ABOVE REFERENCED MAP, AND SCALE IS APPROXIMATE. FOR USE WITH LFR REPORT ONLY.



- LEGEND:**
- PROPERTY LINE
 - FENCELINE
 - STORM DRAIN LINE
 - SANITARY SEWER LINE
 - CONTOUR
 - EPL5 [Symbol] SOIL GAS MONITORING WELL
 - ATC-4 [Symbol] ATC GROUNDWATER MONITORING WELL
 - [Symbol] HVAC UNIT
 - [Symbol] TRANSFORMER
 - CB [Symbol] CATCH BASIN
 - [Symbol] SVE SHED (LOCATION APPROXIMATE)
 - AREAS OF SETTLING OR EROSION (APPROXIMATE)

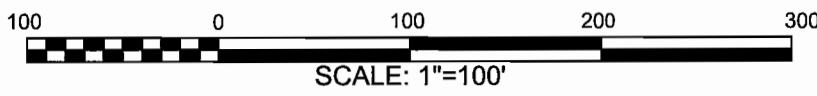
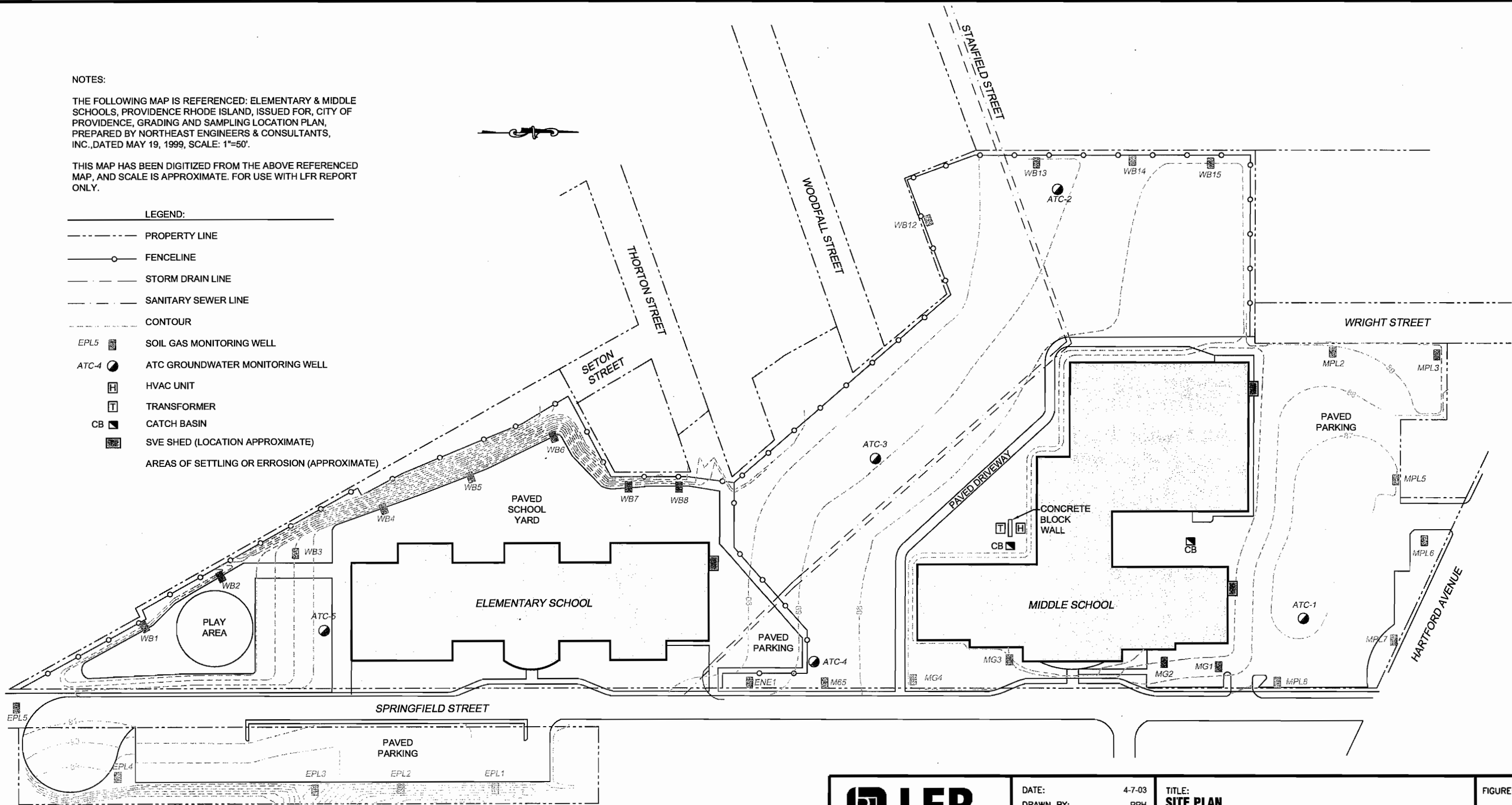

 250 Centerville Road Building E, Suite 12 Warwick, Rhode Island 02886 Phone: (401) 738-3887 Fax: (401) 732-1686	DATE: 4-7-03 DRAWN BY: PPH REVIEWED BY: DP APPROVED BY: DP SCALE: AS NOTED FILE NO: 081-12027-00 JOB NO: 081-12027-00	TITLE: SITE PLAN LOCATION: SPRINGFIELD STREET SCHOOL COMPLEX SPRINGFIELD STREET PROVIDENCE, RHODE ISLAND	FIGURE: 1
--	---	---	-------------------------

Attachment A

Laboratory Report for Groundwater

LEVINE FRICKE
 350 METRO CENTER BLVD., SUITE 250
 WARWICK, RI 02886
 ATTN: DONNA PALLISTER

CONTRACT NUMBER:
 PURCHASE ORDER NUMBER: 5131

PROJECT NUMBER:

ANALYTICAL SUMMARY

LIMS BAT #: LIMS-95167
 JOB NUMBER: 081-12152-02

The results of analyses performed on the following samples submitted to the CON-TEST Analytical Laboratory are found in this report.

PROJECT LOCATION: SPRINGFIELD STREET SCHOOL, PROVIDENCE, RI.

FIELD SAMPLE #	LAB ID	MATRIX	SAMPLE DESCRIPTION	TEST
ATC-1	06B04084	GRND WATER	NOT SPECIFIED	8260 water
ATC-2	06B04085	GRND WATER	NOT SPECIFIED	8260 water
ATC-3	06B04086	GRND WATER	NOT SPECIFIED	8260 water
ATC-4	06B04087	GRND WATER	NOT SPECIFIED	8260 water
ATC-5	06B04088	GRND WATER	NOT SPECIFIED	8260 water

Comments :

LIMS BATCH NO. : LIMS-95167

IN METHOD 8260 WATER FOR SAMPLES 06B04084 - 04088, THE REPORTED RESULTS FOR TERTIARY BUTYL ALCOHOL, 1,4-DIOXANE, DICHLORODIFLUOROMETHANE, TRICHLOROFLUOROMETHANE, 2,2-DICHLOROPROPANE, CARBON TETRACHLORIDE, DIBROMOCHLOROMETHANE, BROMOFORM, ACETONE, METHYLENE CHLORIDE, CIS-1,3-DICHLOROPROPENE, AND 1,2-DIBROMOETHANE ARE ESTIMATED. EITHER THE INITIAL OR CONTINUING CALIBRATION DID NOT MEET REQUIRED CRITERIA.

The CON-TEST Environmental Laboratory operates under the following certifications and accreditations :

AIHA 100033	AIHA ELLAP (LEAD) 100033	
MASSACHUSETTS MA0100	NEW HAMPSHIRE NELAP 2516	NEW JERSEY NELAP NJ MA007 (AIR)
CONNECTICUT PH-0567	VERMONT DOH (LEAD) No. LL015036	ARIZONA AZ0648
NEW YORK ELAP/NELAP 10899	RHODE ISLAND (LIC. No. 112)	ARIZONA AZ0654 (AIR)

I certify that the analyses listed above, unless specifically listed as subcontracted, if any, were performed under my direction according to the approved methodologies listed in this document, and that based upon my inquiry of those individuals immediately responsible for obtaining the information, the material contained in this report is, to the best of my knowledge and belief, accurate and complete.

Edward Denson 2/10/06

Tod Kopyscinski
 Director of Operations

Sondra L. Slesinski
 Quality Assurance Officer

SIGNATURE

DATE

Edward Denson
 Technical Director

* See end of data tabulation for notes and comments pertaining to this sample

DONNA PALLISTER
 LEVINE FRICKE
 350 METRO CENTER BLVD., SUITE 250
 WARWICK, RI 02886

2/10/2006
 Page 1 of 16

Purchase Order No.: 5131

Project Location: SPRINGFIELD STREET SCHOOL, PROVIDENCE, RI.
 Date Received: 2/6/2006

LIMS-BAT #: LIMS-95167
 Job Number: 081-12152-02

Field Sample #: ATC-1

Sample ID: 06B04084 Sampled: 2/2/2006
 NOT SPECIFIED

Sample Matrix: GRND WATER

	Units	Results	RL	Method	Date Analyzed	Analyst
8260 water				SW846 8260		
Acetone	ug/l	ND	50.0		02/07/06	LBD
Acrylonitrile	ug/l	ND	5.0		02/07/06	LBD
tert-Amyl methyl Ether	ug/l	ND	0.5		02/07/06	LBD
Benzene	ug/l	ND	1.0		02/07/06	LBD
Bromobenzene	ug/l	ND	1.0		02/07/06	LBD
Bromochloromethane	ug/l	ND	1.0		02/07/06	LBD
Bromodichloromethane	ug/l	ND	1.0		02/07/06	LBD
Bromoform	ug/l	ND	3.0		02/07/06	LBD
Bromomethane	ug/l	ND	2.0		02/07/06	LBD
2-Butanone (MEK)	ug/l	ND	20.0		02/07/06	LBD
tert-Butyl Alcohol	ug/l	ND	25.0		02/07/06	LBD
n-Butylbenzene	ug/l	ND	1.0		02/07/06	LBD
sec-Butylbenzene	ug/l	ND	1.0		02/07/06	LBD
tert-Butylbenzene	ug/l	ND	1.0		02/07/06	LBD
tert-Butylethyl Ether	ug/l	ND	0.5		02/07/06	LBD
Carbon Disulfide	ug/l	ND	3.0		02/07/06	LBD
Carbon Tetrachloride	ug/l	ND	1.0		02/07/06	LBD
Chlorobenzene	ug/l	ND	1.0		02/07/06	LBD
Chlorodibromomethane	ug/l	ND	0.5		02/07/06	LBD
Chloroethane	ug/l	ND	2.0		02/07/06	LBD
Chloroform	ug/l	ND	2.0		02/07/06	LBD
Chloromethane	ug/l	ND	2.0		02/07/06	LBD
2-Chlorotoluene	ug/l	ND	1.0		02/07/06	LBD
4-Chlorotoluene	ug/l	ND	1.0		02/07/06	LBD
1,2-Dibromo-3-Chloropropane	ug/l	ND	5.0		02/07/06	LBD
1,2-Dibromoethane	ug/l	ND	0.50		02/07/06	LBD
Dibromomethane	ug/l	ND	1.0		02/07/06	LBD
1,2-Dichlorobenzene	ug/l	ND	1.0		02/07/06	LBD
1,3-Dichlorobenzene	ug/l	ND	1.0		02/07/06	LBD
1,4-Dichlorobenzene	ug/l	ND	1.0		02/07/06	LBD
trans-1,4-Dichloro-2-Butene	ug/l	ND	3.0		02/07/06	LBD
Dichlorodifluoromethane	ug/l	ND	2.0		02/07/06	LBD
1,1-Dichloroethane	ug/l	ND	1.0		02/07/06	LBD
1,2-Dichloroethane	ug/l	ND	1.0		02/07/06	LBD
1,1-Dichloroethylene	ug/l	ND	1.0		02/07/06	LBD
cis-1,2-Dichloroethylene	ug/l	ND	1.0		02/07/06	LBD

RL = Reporting Limit

ND = Not Detected at or above the Reporting Limit

NM = Not Measured

* = See end of report for comments and notes applying to this sample

DONNA PALLISTER
 LEVINE FRICKE
 350 METRO CENTER BLVD., SUITE 250
 WARWICK, RI 02886

2/10/2006
 Page 2 of 16

Purchase Order No.: 5131

Project Location: SPRINGFIELD STREET SCHOOL, PROVIDENCE, RI.
 Date Received: 2/6/2006

LIMS-BAT #: LIMS-95167
 Job Number: 081-12152-02

Field Sample #: ATC-1

Sample ID : 06B04084 Sampled : 2/2/2006
 NOT SPECIFIED

Sample Matrix: GRND WATER

	Units	Results	RL	Method	Date Analyzed	Analyst
8260 water				SW846 8260		
trans-1,2-Dichloroethylene	ug/l	ND	1.0		02/07/06	LBD
1,2-Dichloropropane	ug/l	ND	1.0		02/07/06	LBD
1,3-Dichloropropane	ug/l	ND	0.5		02/07/06	LBD
2,2-Dichloropropane	ug/l	ND	1.0		02/07/06	LBD
1,1-Dichloropropene	ug/l	ND	2.0		02/07/06	LBD
cis-1,3-Dichloropropene	ug/l	ND	0.5		02/07/06	LBD
trans-1,3-Dichloropropene	ug/l	ND	3.0		02/07/06	LBD
Diethyl Ether	ug/l	ND	2.0		02/07/06	LBD
Diisopropyl Ether	ug/l	ND	0.5		02/07/06	LBD
1,4-Dioxane	ug/l	ND	50.0		02/07/06	LBD
Ethyl Benzene	ug/l	ND	1.0		02/07/06	LBD
Hexachlorobutadiene	ug/l	ND	1.0		02/07/06	LBD
2-Hexanone	ug/l	ND	10.0		02/07/06	LBD
Isopropylbenzene	ug/l	ND	1.0		02/07/06	LBD
p-Isopropyltoluene	ug/l	ND	1.0		02/07/06	LBD
MTBE	ug/l	ND	1.0		02/07/06	LBD
Methylene Chloride	ug/l	ND	5.0		02/07/06	LBD
MIBK	ug/l	ND	10.0		02/07/06	LBD
Naphthalene	ug/l	ND	3.0		02/07/06	LBD
n-Propylbenzene	ug/l	ND	1.0		02/07/06	LBD
Styrene	ug/l	ND	1.0		02/07/06	LBD
1,1,1,2-Tetrachloroethane	ug/l	ND	2.0		02/07/06	LBD
1,1,2,2-Tetrachloroethane	ug/l	ND	0.5		02/07/06	LBD
Tetrachloroethylene	ug/l	ND	1.0		02/07/06	LBD
Tetrahydrofuran	ug/l	ND	10.0		02/07/06	LBD
Toluene	ug/l	ND	1.0		02/07/06	LBD
1,2,3-Trichlorobenzene	ug/l	ND	5.0		02/07/06	LBD
1,2,4-Trichlorobenzene	ug/l	ND	2.0		02/07/06	LBD
1,1,1-Trichloroethane	ug/l	ND	1.0		02/07/06	LBD
1,1,2-Trichloroethane	ug/l	1.2	1.0		02/07/06	LBD
Trichloroethylene	ug/l	1.3	1.0		02/07/06	LBD
Trichlorofluoromethane	ug/l	ND	2.0		02/07/06	LBD
1,2,3-Trichloropropane	ug/l	ND	2.0		02/07/06	LBD
1,1,2-Trichloro-1,2,2-Trifluoroethane	ug/l	ND	5.0		02/07/06	LBD
1,2,4-Trimethylbenzene	ug/l	ND	1.0		02/07/06	LBD
1,3,5-Trimethylbenzene	ug/l	ND	1.0		02/07/06	LBD

RL = Reporting Limit

ND = Not Detected at or above the Reporting Limit

NM = Not Measured

* = See end of report for comments and notes applying to this sample

DONNA PALLISTER

LEVINE FRICKE

2/10/2006

350 METRO CENTER BLVD., SUITE 250

Page 3 of 16

WARWICK, RI 02886

Purchase Order No.: 5131

Project Location: SPRINGFIELD STREET SCHOOL, PROVIDENCE, RI.

LIMS-BAT #: LIMS-95167

Date Received: 2/6/2006

Job Number: 081-12152-02

Field Sample #: ATC-1

Sample ID: 06B04084

Sampled: 2/2/2006

NOT SPECIFIED

Sample Matrix: GRND WATER

	Units	Results	RL	Method	Date Analyzed	Analyst
8260 water				SW846 8260		
Vinyl Chloride	ug/l	ND	2.0		02/07/06	LBD
m + p Xylene	ug/l	ND	2.0		02/07/06	LBD
o-Xylene	ug/l	ND	1.0		02/07/06	LBD

RL = Reporting Limit

ND = Not Detected at or above the Reporting Limit

NM = Not Measured

* = See end of report for comments and notes applying to this sample

DONNA PALLISTER
 LEVINE FRICKE
 350 METRO CENTER BLVD., SUITE 250
 WARWICK, RI 02886

2/10/2006
 Page 4 of 16

Purchase Order No.: 5131

Project Location: SPRINGFIELD STREET SCHOOL, PROVIDENCE, RI.
 Date Received: 2/6/2006

LIMS-BAT #: LIMS-95167
 Job Number: 081-12152-02

Field Sample #: ATC-2

Sample ID: 06B04085 Sampled: 2/2/2006
 NOT SPECIFIED

Sample Matrix: GRND WATER

	Units	Results	RL	Method	Date Analyzed	Analyst
8260 water				SW846 8260		
Acetone	ug/l	ND	50.0		02/07/06	LBD
Acrylonitrile	ug/l	ND	5.0		02/07/06	LBD
tert-Amylmethyl Ether	ug/l	ND	0.5		02/07/06	LBD
Benzene	ug/l	ND	1.0		02/07/06	LBD
Bromobenzene	ug/l	ND	1.0		02/07/06	LBD
Bromochloromethane	ug/l	ND	1.0		02/07/06	LBD
Bromodichloromethane	ug/l	ND	1.0		02/07/06	LBD
Bromoform	ug/l	ND	3.0		02/07/06	LBD
Bromomethane	ug/l	ND	2.0		02/07/06	LBD
2-Butanone (MEK)	ug/l	ND	20.0		02/07/06	LBD
tert-Butyl Alcohol	ug/l	ND	25.0		02/07/06	LBD
n-Butylbenzene	ug/l	ND	1.0		02/07/06	LBD
sec-Butylbenzene	ug/l	ND	1.0		02/07/06	LBD
tert-Butylbenzene	ug/l	ND	1.0		02/07/06	LBD
tert-Butylethyl Ether	ug/l	ND	0.5		02/07/06	LBD
Carbon Disulfide	ug/l	ND	3.0		02/07/06	LBD
Carbon Tetrachloride	ug/l	ND	1.0		02/07/06	LBD
Chlorobenzene	ug/l	ND	1.0		02/07/06	LBD
Chlorodibromomethane	ug/l	ND	0.5		02/07/06	LBD
Chloroethane	ug/l	ND	2.0		02/07/06	LBD
Chloroform	ug/l	ND	2.0		02/07/06	LBD
Chloromethane	ug/l	ND	2.0		02/07/06	LBD
2-Chlorotoluene	ug/l	ND	1.0		02/07/06	LBD
4-Chlorotoluene	ug/l	ND	1.0		02/07/06	LBD
1,2-Dibromo-3-Chloropropane	ug/l	ND	5.0		02/07/06	LBD
1,2-Dibromoethane	ug/l	ND	0.50		02/07/06	LBD
Dibromomethane	ug/l	ND	1.0		02/07/06	LBD
1,2-Dichlorobenzene	ug/l	ND	1.0		02/07/06	LBD
1,3-Dichlorobenzene	ug/l	ND	1.0		02/07/06	LBD
1,4-Dichlorobenzene	ug/l	ND	1.0		02/07/06	LBD
trans-1,4-Dichloro-2-Butene	ug/l	ND	3.0		02/07/06	LBD
Dichlorodifluoromethane	ug/l	ND	2.0		02/07/06	LBD
1,1-Dichloroethane	ug/l	ND	1.0		02/07/06	LBD
1,2-Dichloroethane	ug/l	ND	1.0		02/07/06	LBD
1,1-Dichloroethylene	ug/l	ND	1.0		02/07/06	LBD
cis-1,2-Dichloroethylene	ug/l	ND	1.0		02/07/06	LBD

RL = Reporting Limit

ND = Not Detected at or above the Reporting Limit

NM = Not Measured

* = See end of report for comments and notes applying to this sample

DONNA PALLISTER
 LEVINE FRICKE
 350 METRO CENTER BLVD., SUITE 250
 WARWICK, RI 02886

Purchase Order No.: 5131

2/10/2006
 Page 5 of 16

Project Location: SPRINGFIELD STREET SCHOOL, PROVIDENCE, RI.
 Date Received: 2/6/2006

LIMS-BAT #: LIMS-95167
 Job Number: 081-12152-02

Field Sample #: ATC-2

Sample ID: 06B04085 Sampled: 2/2/2006
 NOT SPECIFIED

Sample Matrix: GRND WATER

	Units	Results	RL	Method	Date Analyzed	Analyst
8260 water				SW846 8260		
trans-1,2-Dichloroethylene	ug/l	ND	1.0		02/07/06	LBD
1,2-Dichloropropane	ug/l	ND	1.0		02/07/06	LBD
1,3-Dichloropropane	ug/l	ND	0.5		02/07/06	LBD
2,2-Dichloropropane	ug/l	ND	1.0		02/07/06	LBD
1,1-Dichloropropene	ug/l	ND	2.0		02/07/06	LBD
cis-1,3-Dichloropropene	ug/l	ND	0.5		02/07/06	LBD
trans-1,3-Dichloropropene	ug/l	ND	3.0		02/07/06	LBD
Diethyl Ether	ug/l	ND	2.0		02/07/06	LBD
Diisopropyl Ether	ug/l	ND	0.5		02/07/06	LBD
1,4-Dioxane	ug/l	ND	50.0		02/07/06	LBD
Ethyl Benzene	ug/l	ND	1.0		02/07/06	LBD
Hexachlorobutadiene	ug/l	ND	1.0		02/07/06	LBD
2-Hexanone	ug/l	ND	10.0		02/07/06	LBD
Isopropylbenzene	ug/l	ND	1.0		02/07/06	LBD
p-Isopropyltoluene	ug/l	ND	1.0		02/07/06	LBD
MTBE	ug/l	ND	1.0		02/07/06	LBD
Methylene Chloride	ug/l	ND	5.0		02/07/06	LBD
MIBK	ug/l	ND	10.0		02/07/06	LBD
Naphthalene	ug/l	ND	3.0		02/07/06	LBD
n-Propylbenzene	ug/l	ND	1.0		02/07/06	LBD
Styrene	ug/l	ND	1.0		02/07/06	LBD
1,1,1,2-Tetrachloroethane	ug/l	ND	2.0		02/07/06	LBD
1,1,2,2-Tetrachloroethane	ug/l	ND	0.5		02/07/06	LBD
Tetrachloroethylene	ug/l	ND	1.0		02/07/06	LBD
Tetrahydrofuran	ug/l	ND	10.0		02/07/06	LBD
Toluene	ug/l	ND	1.0		02/07/06	LBD
1,2,3-Trichlorobenzene	ug/l	ND	5.0		02/07/06	LBD
1,2,4-Trichlorobenzene	ug/l	ND	2.0		02/07/06	LBD
1,1,1-Trichloroethane	ug/l	ND	1.0		02/07/06	LBD
1,1,2-Trichloroethane	ug/l	ND	1.0		02/07/06	LBD
Trichloroethylene	ug/l	ND	1.0		02/07/06	LBD
Trichlorofluoromethane	ug/l	ND	2.0		02/07/06	LBD
1,2,3-Trichloropropane	ug/l	ND	2.0		02/07/06	LBD
1,1,2-Trichloro-1,2,2-Trifluoroethane	ug/l	ND	5.0		02/07/06	LBD
1,2,4-Trimethylbenzene	ug/l	ND	1.0		02/07/06	LBD
1,3,5-Trimethylbenzene	ug/l	ND	1.0		02/07/06	LBD

RL = Reporting Limit

ND = Not Detected at or above the Reporting Limit

NM = Not Measured

* = See end of report for comments and notes applying to this sample

DONNA PALLISTER
LEVINE FRICKE
350 METRO CENTER BLVD., SUITE 250
WARWICK, RI 02886

2/10/2006
Page 6 of 16

Purchase Order No.: 5131

Project Location: SPRINGFIELD STREET SCHOOL, PROVIDENCE, RI.
Date Received: 2/6/2006

LIMS-BAT #: LIMS-95167
Job Number: 081-12152-02

Field Sample #: ATC-2

Sample ID : 06B04085 Sampled : 2/2/2006
NOT SPECIFIED

Sample Matrix: GRND WATER

	Units	Results	RL	Method	Date Analyzed	Analyst
8260 water				SW846 8260		
Vinyl Chloride	ug/l	ND	2.0		02/07/06	LBD
m + p Xylene	ug/l	ND	2.0		02/07/06	LBD
o-Xylene	ug/l	ND	1.0		02/07/06	LBD

RL = Reporting Limit

ND = Not Detected at or above the Reporting Limit

NM = Not Measured

* = See end of report for comments and notes applying to this sample

DONNA PALLISTER
 LEVINE FRICKE
 350 METRO CENTER BLVD., SUITE 250
 WARWICK, RI 02886

2/10/2006
 Page 7 of 16

Purchase Order No.: 5131

Project Location: SPRINGFIELD STREET SCHOOL, PROVIDENCE, RI.
 Date Received: 2/6/2006

LIMS-BAT #: LIMS-95167
 Job Number: 081-12152-02

Field Sample #: ATC-3

Sample ID: 06B04086 Sampled: 2/2/2006
 NOT SPECIFIED

Sample Matrix: GRND WATER

	Units	Results	RL	Method	Date Analyzed	Analyst
8260 water				SW846 8260		
Acetone	ug/l	ND	50.0		02/07/06	LBD
Acrylonitrile	ug/l	ND	5.0		02/07/06	LBD
tert-Amyl methyl Ether	ug/l	ND	0.5		02/07/06	LBD
Benzene	ug/l	ND	1.0		02/07/06	LBD
Bromobenzene	ug/l	ND	1.0		02/07/06	LBD
Bromochloromethane	ug/l	ND	1.0		02/07/06	LBD
Bromodichloromethane	ug/l	ND	1.0		02/07/06	LBD
Bromoform	ug/l	ND	3.0		02/07/06	LBD
Bromomethane	ug/l	ND	2.0		02/07/06	LBD
2-Butanone (MEK)	ug/l	ND	20.0		02/07/06	LBD
tert-Butyl Alcohol	ug/l	ND	25.0		02/07/06	LBD
n-Butylbenzene	ug/l	ND	1.0		02/07/06	LBD
sec-Butylbenzene	ug/l	ND	1.0		02/07/06	LBD
tert-Butylbenzene	ug/l	ND	1.0		02/07/06	LBD
tert-Butylethyl Ether	ug/l	ND	0.5		02/07/06	LBD
Carbon Disulfide	ug/l	ND	3.0		02/07/06	LBD
Carbon Tetrachloride	ug/l	ND	1.0		02/07/06	LBD
Chlorobenzene	ug/l	ND	1.0		02/07/06	LBD
Chlorodibromomethane	ug/l	ND	0.5		02/07/06	LBD
Chloroethane	ug/l	ND	2.0		02/07/06	LBD
Chloroform	ug/l	ND	2.0		02/07/06	LBD
Chloromethane	ug/l	ND	2.0		02/07/06	LBD
2-Chlorotoluene	ug/l	ND	1.0		02/07/06	LBD
4-Chlorotoluene	ug/l	ND	1.0		02/07/06	LBD
1,2-Dibromo-3-Chloropropane	ug/l	ND	5.0		02/07/06	LBD
1,2-Dibromoethane	ug/l	ND	0.50		02/07/06	LBD
Dibromomethane	ug/l	ND	1.0		02/07/06	LBD
1,2-Dichlorobenzene	ug/l	ND	1.0		02/07/06	LBD
1,3-Dichlorobenzene	ug/l	ND	1.0		02/07/06	LBD
1,4-Dichlorobenzene	ug/l	ND	1.0		02/07/06	LBD
trans-1,4-Dichloro-2-Butene	ug/l	ND	3.0		02/07/06	LBD
Dichlorodifluoromethane	ug/l	ND	2.0		02/07/06	LBD
1,1-Dichloroethane	ug/l	ND	1.0		02/07/06	LBD
1,2-Dichloroethane	ug/l	ND	1.0		02/07/06	LBD
1,1-Dichloroethylene	ug/l	ND	1.0		02/07/06	LBD
cis-1,2-Dichloroethylene	ug/l	ND	1.0		02/07/06	LBD

RL = Reporting Limit

ND = Not Detected at or above the Reporting Limit

NM = Not Measured

* = See end of report for comments and notes applying to this sample

DONNA PALLISTER
 LEVINE FRICKE
 350 METRO CENTER BLVD., SUITE 250
 WARWICK, RI 02886

Purchase Order No.: 5131

2/10/2006
 Page 8 of 16

Project Location: SPRINGFIELD STREET SCHOOL, PROVIDENCE, RI.
 Date Received: 2/6/2006

LIMS-BAT #: LIMS-95167
 Job Number: 081-12152-02

Field Sample # : ATC-3

Sample ID : 06B04086 **Sampled :** 2/2/2006
 NOT SPECIFIED

Sample Matrix: GRND WATER

	Units	Results	RL	Method	Date Analyzed	Analyst
8260 water				SW846 8260		
trans-1,2-Dichloroethylene	ug/l	ND	1.0		02/07/06	LBD
1,2-Dichloropropane	ug/l	ND	1.0		02/07/06	LBD
1,3-Dichloropropane	ug/l	ND	0.5		02/07/06	LBD
2,2-Dichloropropane	ug/l	ND	1.0		02/07/06	LBD
1,1-Dichloropropene	ug/l	ND	2.0		02/07/06	LBD
cis-1,3-Dichloropropene	ug/l	ND	0.5		02/07/06	LBD
trans-1,3-Dichloropropene	ug/l	ND	3.0		02/07/06	LBD
Diethyl Ether	ug/l	ND	2.0		02/07/06	LBD
Diisopropyl Ether	ug/l	ND	0.5		02/07/06	LBD
1,4-Dioxane	ug/l	ND	50.0		02/07/06	LBD
Ethyl Benzene	ug/l	ND	1.0		02/07/06	LBD
Hexachlorobutadiene	ug/l	ND	1.0		02/07/06	LBD
2-Hexanone	ug/l	ND	10.0		02/07/06	LBD
Isopropylbenzene	ug/l	ND	1.0		02/07/06	LBD
p-Isopropyltoluene	ug/l	ND	1.0		02/07/06	LBD
MTBE	ug/l	ND	1.0		02/07/06	LBD
Methylene Chloride	ug/l	ND	5.0		02/07/06	LBD
MIBK	ug/l	ND	10.0		02/07/06	LBD
Naphthalene	ug/l	ND	3.0		02/07/06	LBD
n-Propylbenzene	ug/l	ND	1.0		02/07/06	LBD
Styrene	ug/l	ND	1.0		02/07/06	LBD
1,1,1,2-Tetrachloroethane	ug/l	ND	2.0		02/07/06	LBD
1,1,2,2-Tetrachloroethane	ug/l	ND	0.5		02/07/06	LBD
Tetrachloroethylene	ug/l	ND	1.0		02/07/06	LBD
Tetrahydrofuran	ug/l	ND	10.0		02/07/06	LBD
Toluene	ug/l	3.0	1.0		02/07/06	LBD
1,2,3-Trichlorobenzene	ug/l	ND	5.0		02/07/06	LBD
1,2,4-Trichlorobenzene	ug/l	ND	2.0		02/07/06	LBD
1,1,1-Trichloroethane	ug/l	ND	1.0		02/07/06	LBD
1,1,2-Trichloroethane	ug/l	ND	1.0		02/07/06	LBD
Trichloroethylene	ug/l	ND	1.0		02/07/06	LBD
Trichlorofluoromethane	ug/l	ND	2.0		02/07/06	LBD
1,2,3-Trichloropropane	ug/l	ND	2.0		02/07/06	LBD
1,1,2-Trichloro-1,2,2-Trifluoroethane	ug/l	ND	5.0		02/07/06	LBD
1,2,4-Trimethylbenzene	ug/l	ND	1.0		02/07/06	LBD
1,3,5-Trimethylbenzene	ug/l	ND	1.0		02/07/06	LBD

RL = Reporting Limit

ND = Not Detected at or above the Reporting Limit

NM = Not Measured

* = See end of report for comments and notes applying to this sample

DONNA PALLISTER

LEVINE FRICKE

2/10/2006

350 METRO CENTER BLVD., SUITE 250

Page 9 of 16

WARWICK, RI 02886

Purchase Order No.: 5131

Project Location: SPRINGFIELD STREET SCHOOL, PROVIDENCE, RI.

LIMS-BAT #: LIMS-95167

Date Received: 2/6/2006

Job Number: 081-12152-02

Field Sample # : ATC-3

Sample ID : 06B04086

Sampled : 2/2/2006

NOT SPECIFIED

Sample Matrix: GRND WATER

	Units	Results	RL	Method	Date Analyzed	Analyst
8260 water				SW846 8260		
Vinyl Chloride	ug/l	ND	2.0		02/07/06	LBD
m + p Xylene	ug/l	ND	2.0		02/07/06	LBD
o-Xylene	ug/l	ND	1.0		02/07/06	LBD

RL = Reporting Limit

ND = Not Detected at or above the Reporting Limit

NM = Not Measured

* = See end of report for comments and notes applying to this sample

DONNA PALLISTER
 LEVINE FRICKE
 350 METRO CENTER BLVD., SUITE 250
 WARWICK, RI 02886

2/10/2006
 Page 10 of 16

Purchase Order No.: 5131

Project Location: SPRINGFIELD STREET SCHOOL, PROVIDENCE, RI.
 Date Received: 2/6/2006

LIMS-BAT #: LIMS-95167
 Job Number: 081-12152-02

Field Sample #: ATC-4

Sample ID: 06B04087 Sampled: 2/2/2006
 NOT SPECIFIED

Sample Matrix: GRND WATER

	Units	Results	RL	Method	Date Analyzed	Analyst
8260 water				SW846 8260		
Acetone	ug/l	ND	50.0		02/07/06	LBD
Acrylonitrile	ug/l	ND	5.0		02/07/06	LBD
tert-Amylmethyl Ether	ug/l	ND	0.5		02/07/06	LBD
Benzene	ug/l	ND	1.0		02/07/06	LBD
Bromobenzene	ug/l	ND	1.0		02/07/06	LBD
Bromochloromethane	ug/l	ND	1.0		02/07/06	LBD
Bromodichloromethane	ug/l	ND	1.0		02/07/06	LBD
Bromoform	ug/l	ND	3.0		02/07/06	LBD
Bromomethane	ug/l	ND	2.0		02/07/06	LBD
2-Butanone (MEK)	ug/l	ND	20.0		02/07/06	LBD
tert-Butyl Alcohol	ug/l	ND	25.0		02/07/06	LBD
n-Butylbenzene	ug/l	ND	1.0		02/07/06	LBD
sec-Butylbenzene	ug/l	ND	1.0		02/07/06	LBD
tert-Butylbenzene	ug/l	ND	1.0		02/07/06	LBD
tert-Butylethyl Ether	ug/l	ND	0.5		02/07/06	LBD
Carbon Disulfide	ug/l	ND	3.0		02/07/06	LBD
Carbon Tetrachloride	ug/l	ND	1.0		02/07/06	LBD
Chlorobenzene	ug/l	ND	1.0		02/07/06	LBD
Chlorodibromomethane	ug/l	ND	0.5		02/07/06	LBD
Chloroethane	ug/l	ND	2.0		02/07/06	LBD
Chloroform	ug/l	ND	2.0		02/07/06	LBD
Chloromethane	ug/l	ND	2.0		02/07/06	LBD
2-Chlorotoluene	ug/l	ND	1.0		02/07/06	LBD
4-Chlorotoluene	ug/l	ND	1.0		02/07/06	LBD
1,2-Dibromo-3-Chloropropane	ug/l	ND	5.0		02/07/06	LBD
1,2-Dibromoethane	ug/l	ND	0.50		02/07/06	LBD
Dibromomethane	ug/l	ND	1.0		02/07/06	LBD
1,2-Dichlorobenzene	ug/l	ND	1.0		02/07/06	LBD
1,3-Dichlorobenzene	ug/l	ND	1.0		02/07/06	LBD
1,4-Dichlorobenzene	ug/l	ND	1.0		02/07/06	LBD
trans-1,4-Dichloro-2-Butene	ug/l	ND	3.0		02/07/06	LBD
Dichlorodifluoromethane	ug/l	ND	2.0		02/07/06	LBD
1,1-Dichloroethane	ug/l	ND	1.0		02/07/06	LBD
1,2-Dichloroethane	ug/l	ND	1.0		02/07/06	LBD
1,1-Dichloroethylene	ug/l	ND	1.0		02/07/06	LBD
cis-1,2-Dichloroethylene	ug/l	ND	1.0		02/07/06	LBD

RL = Reporting Limit

ND = Not Detected at or above the Reporting Limit

NM = Not Measured

* = See end of report for comments and notes applying to this sample

DONNA PALLISTER
 LEVINE FRICKE
 350 METRO CENTER BLVD., SUITE 250
 WARWICK, RI 02886

2/10/2006
 Page 11 of 16

Purchase Order No.: 5131

Project Location: SPRINGFIELD STREET SCHOOL, PROVIDENCE, RI.
 Date Received: 2/6/2006

LIMS-BAT #: LIMS-95167
 Job Number: 081-12152-02

Field Sample #: ATC-4

Sample ID : 06B04087 Sampled : 2/2/2006
 NOT SPECIFIED

Sample Matrix: GRND WATER

	Units	Results	RL	Method	Date Analyzed	Analyst
8260 water				SW846 8260		
trans-1,2-Dichloroethylene	ug/l	ND	1.0		02/07/06	LBD
1,2-Dichloropropane	ug/l	ND	1.0		02/07/06	LBD
1,3-Dichloropropane	ug/l	ND	0.5		02/07/06	LBD
2,2-Dichloropropane	ug/l	ND	1.0		02/07/06	LBD
1,1-Dichloropropene	ug/l	ND	2.0		02/07/06	LBD
cis-1,3-Dichloropropene	ug/l	ND	0.5		02/07/06	LBD
trans-1,3-Dichloropropene	ug/l	ND	3.0		02/07/06	LBD
Diethyl Ether	ug/l	ND	2.0		02/07/06	LBD
Diisopropyl Ether	ug/l	ND	0.5		02/07/06	LBD
1,4-Dioxane	ug/l	ND	50.0		02/07/06	LBD
Ethyl Benzene	ug/l	ND	1.0		02/07/06	LBD
Hexachlorobutadiene	ug/l	ND	1.0		02/07/06	LBD
2-Hexanone	ug/l	ND	10.0		02/07/06	LBD
Isopropylbenzene	ug/l	ND	1.0		02/07/06	LBD
p-Isopropyltoluene	ug/l	ND	1.0		02/07/06	LBD
MTBE	ug/l	ND	1.0		02/07/06	LBD
Methylene Chloride	ug/l	ND	5.0		02/07/06	LBD
MIBK	ug/l	ND	10.0		02/07/06	LBD
Naphthalene	ug/l	ND	3.0		02/07/06	LBD
n-Propylbenzene	ug/l	ND	1.0		02/07/06	LBD
Styrene	ug/l	ND	1.0		02/07/06	LBD
1,1,1,2-Tetrachloroethane	ug/l	ND	2.0		02/07/06	LBD
1,1,2,2-Tetrachloroethane	ug/l	ND	0.5		02/07/06	LBD
Tetrachloroethylene	ug/l	ND	1.0		02/07/06	LBD
Tetrahydrofuran	ug/l	ND	10.0		02/07/06	LBD
Toluene	ug/l	ND	1.0		02/07/06	LBD
1,2,3-Trichlorobenzene	ug/l	ND	5.0		02/07/06	LBD
1,2,4-Trichlorobenzene	ug/l	ND	2.0		02/07/06	LBD
1,1,1-Trichloroethane	ug/l	ND	1.0		02/07/06	LBD
1,1,2-Trichloroethane	ug/l	ND	1.0		02/07/06	LBD
Trichloroethylene	ug/l	ND	1.0		02/07/06	LBD
Trichlorofluoromethane	ug/l	ND	2.0		02/07/06	LBD
1,2,3-Trichloropropane	ug/l	ND	2.0		02/07/06	LBD
1,1,2-Trichloro-1,2,2-Trifluoroethane	ug/l	ND	5.0		02/07/06	LBD
1,2,4-Trimethylbenzene	ug/l	ND	1.0		02/07/06	LBD
1,3,5-Trimethylbenzene	ug/l	ND	1.0		02/07/06	LBD

RL = Reporting Limit

ND = Not Detected at or above the Reporting Limit

NM = Not Measured

* = See end of report for comments and notes applying to this sample

DONNA PALLISTER
 LEVINE FRICKE
 350 METRO CENTER BLVD., SUITE 250
 WARWICK, RI 02886

Purchase Order No.: 5131

2/10/2006
 Page 12 of 16

Project Location: SPRINGFIELD STREET SCHOOL, PROVIDENCE, RI.
 Date Received: 2/6/2006

LIMS-BAT #: LIMS-95167
 Job Number: 081-12152-02

Field Sample #: ATC-4

Sample ID: 06B04087 Sampled: 2/2/2006
 NOT SPECIFIED

Sample Matrix: GRND WATER

	Units	Results	RL	Method	Date Analyzed	Analyst
8260 water				SW846 8260		
Vinyl Chloride	ug/l	ND	2.0		02/07/06	LBD
m + p Xylene	ug/l	ND	2.0		02/07/06	LBD
o-Xylene	ug/l	ND	1.0		02/07/06	LBD

RL = Reporting Limit

ND = Not Detected at or above the Reporting Limit

NM = Not Measured

* = See end of report for comments and notes applying to this sample

DONNA PALLISTER
 LEVINE FRICKE
 350 METRO CENTER BLVD., SUITE 250
 WARWICK, RI 02886

2/10/2006
 Page 13 of 16

Purchase Order No.: 5131

Project Location: SPRINGFIELD STREET SCHOOL, PROVIDENCE, RI.
 Date Received: 2/6/2006

LIMS-BAT #: LIMS-95167
 Job Number: 081-12152-02

Field Sample #: ATC-5

Sample ID: 06B04088 Sampled: 2/2/2006
 NOT SPECIFIED

Sample Matrix: GRND WATER

	Units	Results	RL	Method	Date Analyzed	Analyst
8260 water				SW846 8260		
Acetone	ug/l	ND	50.0		02/07/06	LBD
Acrylonitrile	ug/l	ND	5.0		02/07/06	LBD
tert-Amylmethyl Ether	ug/l	ND	0.5		02/07/06	LBD
Benzene	ug/l	ND	1.0		02/07/06	LBD
Bromobenzene	ug/l	ND	1.0		02/07/06	LBD
Bromochloromethane	ug/l	ND	1.0		02/07/06	LBD
Bromodichloromethane	ug/l	ND	1.0		02/07/06	LBD
Bromoform	ug/l	ND	3.0		02/07/06	LBD
Bromomethane	ug/l	ND	2.0		02/07/06	LBD
2-Butanone (MEK)	ug/l	ND	20.0		02/07/06	LBD
tert-Butyl Alcohol	ug/l	ND	25.0		02/07/06	LBD
n-Butylbenzene	ug/l	ND	1.0		02/07/06	LBD
sec-Butylbenzene	ug/l	ND	1.0		02/07/06	LBD
tert-Butylbenzene	ug/l	ND	1.0		02/07/06	LBD
tert-Butylethyl Ether	ug/l	ND	0.5		02/07/06	LBD
Carbon Disulfide	ug/l	ND	3.0		02/07/06	LBD
Carbon Tetrachloride	ug/l	ND	1.0		02/07/06	LBD
Chlorobenzene	ug/l	ND	1.0		02/07/06	LBD
Chlorodibromomethane	ug/l	ND	0.5		02/07/06	LBD
Chloroethane	ug/l	ND	2.0		02/07/06	LBD
Chloroform	ug/l	ND	2.0		02/07/06	LBD
Chloromethane	ug/l	ND	2.0		02/07/06	LBD
2-Chlorotoluene	ug/l	ND	1.0		02/07/06	LBD
4-Chlorotoluene	ug/l	ND	1.0		02/07/06	LBD
1,2-Dibromo-3-Chloropropane	ug/l	ND	5.0		02/07/06	LBD
1,2-Dibromoethane	ug/l	ND	0.50		02/07/06	LBD
Dibromomethane	ug/l	ND	1.0		02/07/06	LBD
1,2-Dichlorobenzene	ug/l	ND	1.0		02/07/06	LBD
1,3-Dichlorobenzene	ug/l	ND	1.0		02/07/06	LBD
1,4-Dichlorobenzene	ug/l	ND	1.0		02/07/06	LBD
trans-1,4-Dichloro-2-Butene	ug/l	ND	3.0		02/07/06	LBD
Dichlorodifluoromethane	ug/l	ND	2.0		02/07/06	LBD
1,1-Dichloroethane	ug/l	ND	1.0		02/07/06	LBD
1,2-Dichloroethane	ug/l	ND	1.0		02/07/06	LBD
1,1-Dichloroethylene	ug/l	ND	1.0		02/07/06	LBD
cis-1,2-Dichloroethylene	ug/l	ND	1.0		02/07/06	LBD

RL = Reporting Limit

ND = Not Detected at or above the Reporting Limit

NM = Not Measured

* = See end of report for comments and notes applying to this sample

DONNA PALLISTER
 LEVINE FRICKE
 350 METRO CENTER BLVD., SUITE 250
 WARWICK, RI 02886

2/10/2006
 Page 14 of 16

Purchase Order No.: 5131

Project Location: SPRINGFIELD STREET SCHOOL, PROVIDENCE, RI.
 Date Received: 2/6/2006

LIMS-BAT #: LIMS-95167
 Job Number: 081-12152-02

Field Sample #: ATC-5

Sample ID: 06B04088 Sampled: 2/2/2006
 NOT SPECIFIED

Sample Matrix: GRND WATER

	Units	Results	RL	Method	Date Analyzed	Analyst
8260 water				SW846 8260		
trans-1,2-Dichloroethylene	ug/l	ND	1.0		02/07/06	LBD
1,2-Dichloropropane	ug/l	ND	1.0		02/07/06	LBD
1,3-Dichloropropane	ug/l	ND	0.5		02/07/06	LBD
2,2-Dichloropropane	ug/l	ND	1.0		02/07/06	LBD
1,1-Dichloropropene	ug/l	ND	2.0		02/07/06	LBD
cis-1,3-Dichloropropene	ug/l	ND	0.5		02/07/06	LBD
trans-1,3-Dichloropropene	ug/l	ND	3.0		02/07/06	LBD
Diethyl Ether	ug/l	ND	2.0		02/07/06	LBD
Diisopropyl Ether	ug/l	ND	0.5		02/07/06	LBD
1,4-Dioxane	ug/l	ND	50.0		02/07/06	LBD
Ethyl Benzene	ug/l	ND	1.0		02/07/06	LBD
Hexachlorobutadiene	ug/l	ND	1.0		02/07/06	LBD
2-Hexanone	ug/l	ND	10.0		02/07/06	LBD
Isopropylbenzene	ug/l	ND	1.0		02/07/06	LBD
p-Isopropyltoluene	ug/l	ND	1.0		02/07/06	LBD
MTBE	ug/l	ND	1.0		02/07/06	LBD
Methylene Chloride	ug/l	ND	5.0		02/07/06	LBD
MIBK	ug/l	ND	10.0		02/07/06	LBD
Naphthalene	ug/l	ND	3.0		02/07/06	LBD
n-Propylbenzene	ug/l	ND	1.0		02/07/06	LBD
Styrene	ug/l	ND	1.0		02/07/06	LBD
1,1,1,2-Tetrachloroethane	ug/l	ND	2.0		02/07/06	LBD
1,1,2,2-Tetrachloroethane	ug/l	ND	0.5		02/07/06	LBD
Tetrachloroethylene	ug/l	ND	1.0		02/07/06	LBD
Tetrahydrofuran	ug/l	ND	10.0		02/07/06	LBD
Toluene	ug/l	ND	1.0		02/07/06	LBD
1,2,3-Trichlorobenzene	ug/l	ND	5.0		02/07/06	LBD
1,2,4-Trichlorobenzene	ug/l	ND	2.0		02/07/06	LBD
1,1,1-Trichloroethane	ug/l	ND	1.0		02/07/06	LBD
1,1,2-Trichloroethane	ug/l	ND	1.0		02/07/06	LBD
Trichloroethylene	ug/l	ND	1.0		02/07/06	LBD
Trichlorofluoromethane	ug/l	ND	2.0		02/07/06	LBD
1,2,3-Trichloropropane	ug/l	ND	2.0		02/07/06	LBD
1,1,2-Trichloro-1,2,2-Trifluoroethane	ug/l	ND	5.0		02/07/06	LBD
1,2,4-Trimethylbenzene	ug/l	ND	1.0		02/07/06	LBD
1,3,5-Trimethylbenzene	ug/l	ND	1.0		02/07/06	LBD

RL = Reporting Limit

ND = Not Detected at or above the Reporting Limit

NM = Not Measured

* = See end of report for comments and notes applying to this sample

DONNA PALLISTER
 LEVINE FRICKE
 350 METRO CENTER BLVD., SUITE 250
 WARWICK, RI 02886

Purchase Order No.: 5131

2/10/2006
 Page 15 of 16

Project Location: SPRINGFIELD STREET SCHOOL, PROVIDENCE, RI.
 Date Received: 2/6/2006

LIMS-BAT #: LIMS-95167
 Job Number: 081-12152-02

Field Sample #: ATC-5

Sample ID: 06B04088 Sampled: 2/2/2006
 NOT SPECIFIED

Sample Matrix: GRND WATER

	Units	Results	RL	Method	Date Analyzed	Analyst
8260 water				SW846 8260		
Vinyl Chloride	ug/l	ND	2.0		02/07/06	LBD
m + p Xylene	ug/l	ND	2.0		02/07/06	LBD
o-Xylene	ug/l	ND	1.0		02/07/06	LBD

RL = Reporting Limit

ND = Not Detected at or above the Reporting Limit

NM = Not Measured

* = See end of report for comments and notes applying to this sample

DONNA PALLISTER
LEVINE FRICKE
350 METRO CENTER BLVD., SUITE 250
WARWICK, RI 02886

Purchase Order No.: 5131

Project Location: SPRINGFIELD STREET SCHOOL, PROVIDENCE, RI.

Date Received: 2/6/2006

2/10/2006

Page 16 of 16

LIMS-BAT #: LIMS-95167

Job Number: 081-12152-02

** END OF REPORT **

RL = Reporting Limit

ND = Not Detected at or above the Reporting Limit

NM = Not Measured

* = See end of report for comments and notes applying to this sample

QC SUMMARY REPORT

SAMPLE QC: Sample Results with Duplicates
Sample Matrix Spikes and Matrix Spike Duplicates

BATCH QC: Lab fortified Blanks and Duplicates
Standard Reference Materials and Duplicates
Method Blanks

Report Date: 2/10/2006 Lims Bat #: LIMS-95167 Page 1 of 4

QC Batch Number: GCMS/VOL-13919

Sample Id	Analysis	QC Analysis	Values	Units	Limits
06B04084	1,2-Dichloroethane-d4	Surrogate Recovery	114.3	%	70-130
	Toluene-d8	Surrogate Recovery	115.7	%	70-130
	Bromofluorobenzene	Surrogate Recovery	108.0	%	70-130
06B04085	1,2-Dichloroethane-d4	Surrogate Recovery	117.1	%	70-130
	Toluene-d8	Surrogate Recovery	114.3	%	70-130
	Bromofluorobenzene	Surrogate Recovery	107.5	%	70-130
06B04086	1,2-Dichloroethane-d4	Surrogate Recovery	120.5	%	70-130
	Toluene-d8	Surrogate Recovery	111.7	%	70-130
	Bromofluorobenzene	Surrogate Recovery	106.0	%	70-130
06B04087	1,2-Dichloroethane-d4	Surrogate Recovery	116.3	%	70-130
	Toluene-d8	Surrogate Recovery	112.8	%	70-130
	Bromofluorobenzene	Surrogate Recovery	108.0	%	70-130
06B04088	1,2-Dichloroethane-d4	Surrogate Recovery	118.5	%	70-130
	Toluene-d8	Surrogate Recovery	116.0	%	70-130
	Bromofluorobenzene	Surrogate Recovery	105.4	%	70-130
BLANK-84118	Acetone	Blank	<50.0	ug/l	
	Benzene	Blank	<1.0	ug/l	
	Carbon Tetrachloride	Blank	<1.0	ug/l	
	Chloroform	Blank	<2.0	ug/l	
	1,2-Dichloroethane	Blank	<1.0	ug/l	
	1,4-Dichlorobenzene	Blank	<1.0	ug/l	
	Ethyl Benzene	Blank	<1.0	ug/l	
	2-Butanone (MEK)	Blank	<20.0	ug/l	
	MIBK	Blank	<10.0	ug/l	
	Naphthalene	Blank	<3.0	ug/l	
	Styrene	Blank	<1.0	ug/l	
	Tetrachloroethylene	Blank	<1.0	ug/l	
	Toluene	Blank	<1.0	ug/l	
	1,1,1-Trichloroethane	Blank	<1.0	ug/l	
	Trichloroethylene	Blank	<1.0	ug/l	
	1,1,2-Trichloro-1,2,2-Trifluoroethane	Blank	<5.0	ug/l	
	Trichlorofluoromethane	Blank	<2.0	ug/l	
	o-Xylene	Blank	<1.0	ug/l	
	m + p Xylene	Blank	<2.0	ug/l	
	1,2-Dichlorobenzene	Blank	<1.0	ug/l	
1,3-Dichlorobenzene	Blank	<1.0	ug/l		
1,1-Dichloroethane	Blank	<1.0	ug/l		
1,1-Dichloroethylene	Blank	<1.0	ug/l		



39 Spruce Street ° East Longmeadow, MA 01028 ° FAX 413/525-6405 ° TEL. 413/525-2332

QC SUMMARY REPORT

SAMPLE QC: Sample Results with Duplicates

BATCH QC: Lab fortified Blanks and Duplicates

Sample Matrix Spikes and Matrix Spike Duplicates

Standard Reference Materials and Duplicates

Method Blanks

Report Date: 2/10/2006

Lims Bat #: LIMS-95167

Page 2 of 4

QC Batch Number: GCMS/VOL-13919

Sample Id	Analysis	QC Analysis	Values	Units	Limits
BLANK-84118	1,4-Dioxane	Blank	<50.0	ug/l	
	MTBE	Blank	<1.0	ug/l	
	trans-1,2-Dichloroethylene	Blank	<1.0	ug/l	
	Vinyl Chloride	Blank	<2.0	ug/l	
	Methylene Chloride	Blank	<5.0	ug/l	
	Chlorobenzene	Blank	<1.0	ug/l	
	Chloromethane	Blank	<2.0	ug/l	
	Bromomethane	Blank	<2.0	ug/l	
	Chloroethane	Blank	<2.0	ug/l	
	cis-1,3-Dichloropropene	Blank	<0.5	ug/l	
	trans-1,3-Dichloropropene	Blank	<3.0	ug/l	
	Chlorodibromomethane	Blank	<0.5	ug/l	
	1,1,2-Trichloroethane	Blank	<1.0	ug/l	
	Bromoform	Blank	<3.0	ug/l	
	1,1,2,2-Tetrachloroethane	Blank	<0.5	ug/l	
	2-Chlorotoluene	Blank	<1.0	ug/l	
	Hexachlorobutadiene	Blank	<1.0	ug/l	
	Isopropylbenzene	Blank	<1.0	ug/l	
	p-Isopropyltoluene	Blank	<1.0	ug/l	
	n-Propylbenzene	Blank	<1.0	ug/l	
	sec-Butylbenzene	Blank	<1.0	ug/l	
	tert-Butylbenzene	Blank	<1.0	ug/l	
	1,2,3-Trichlorobenzene	Blank	<5.0	ug/l	
	1,2,4-Trichlorobenzene	Blank	<2.0	ug/l	
	1,2,4-Trimethylbenzene	Blank	<1.0	ug/l	
	1,3,5-Trimethylbenzene	Blank	<1.0	ug/l	
	Dibromomethane	Blank	<1.0	ug/l	
	cis-1,2-Dichloroethylene	Blank	<1.0	ug/l	
	4-Chlorotoluene	Blank	<1.0	ug/l	
	1,1-Dichloropropene	Blank	<2.0	ug/l	
	1,2-Dichloropropane	Blank	<1.0	ug/l	
	1,3-Dichloropropane	Blank	<0.5	ug/l	
	2,2-Dichloropropane	Blank	<1.0	ug/l	
	1,1,1,2-Tetrachloroethane	Blank	<2.0	ug/l	
	1,2,3-Trichloropropane	Blank	<2.0	ug/l	
	n-Butylbenzene	Blank	<1.0	ug/l	
	Dichlorodifluoromethane	Blank	<2.0	ug/l	
	Bromochloromethane	Blank	<1.0	ug/l	
	Bromobenzene	Blank	<1.0	ug/l	
	Acrylonitrile	Blank	<5.0	ug/l	
	Carbon Disulfide	Blank	<3.0	ug/l	
	2-Hexanone	Blank	<10.0	ug/l	
	trans-1,4-Dichloro-2-Butene	Blank	<3.0	ug/l	



39 Spruce Street ° East Longmeadow, MA 01028 ° FAX 413/525-6405 ° TEL. 413/525-2332

QC SUMMARY REPORT

SAMPLE QC: Sample Results with Duplicates
Sample Matrix Spikes and Matrix Spike Duplicates

BATCH QC: Lab fortified Blanks and Duplicates
Standard Reference Materials and Duplicates
Method Blanks

Report Date: 2/10/2006 Lims Bat #: LIMS-95167 Page 3 of 4

QC Batch Number: GCMS/VOL-13919

Sample Id	Analysis	QC Analysis	Values	Units	Limits
BLANK-84118					
	Diethyl Ether	Blank	<2.0	ug/l	
	Bromodichloromethane	Blank	<1.0	ug/l	
	1,2-Dibromo-3-Chloropropane	Blank	<5.0	ug/l	
	1,2-Dibromoethane	Blank	<0.50	ug/l	
	Tetrahydrofuran	Blank	<10.0	ug/l	
	tert-Butyl Alcohol	Blank	<25.0	ug/l	
	Diisopropyl Ether	Blank	<0.5	ug/l	
	tert-Butylethyl Ether	Blank	<0.5	ug/l	
	tert-Amylmethyl Ether	Blank	<0.5	ug/l	



39 Spruce Street ° East Longmeadow, MA 01028 ° FAX 413/525-6405 ° TEL. 413/525-2332

QC SUMMARY REPORT

SAMPLE QC: Sample Results with Duplicates

BATCH QC: Lab fortified Blanks and Duplicates

Sample Matrix Spikes and Matrix Spike Duplicates

Standard Reference Materials and Duplicates

Method Blanks

Report Date: 2/10/2006

Lims Bat #: LIMS-95167

Page 4 of 4

QUALITY CONTROL DEFINITIONS AND ABBREVIATIONS

QC BATCH NUMBER	This is the number assigned to all samples analyzed together that would be subject to comparison with a particular set of Quality Control Data.
LIMITS	Upper and Lower Control Limits for the QC ANALYSIS Reported. All values normally would fall within these statistically determined limits, unless there is an unusual circumstance that would be documented in a NOTE appearing on the last page of the QC SUMMARY REPORT. Not all QC results will have Limits defined.
Sample Amount	Amount of analyte found in a sample.
Blank	Method Blank that has been taken though all the steps of the analysis.
LFBLANK	Laboratory Fortified Blank (a control sample)
STDADD	Standard Added (a laboratory control sample)
Matrix Spk Amt Added	Amount of analyte spiked into a sample
MS Amt Measured	Amount of analyte found including amount that was spiked
Matrix Spike % Rec.	% Recovery of spiked amount in sample.
Duplicate Value	The result from the Duplicate analysis of the sample.
Duplicate RPD	The Relative Percent Difference between two Duplicate Analyses.
Surrogate Recovery	The % Recovery for non-environmental compounds (surrogates) spiked into samples to determine the performance of the analytical methods.
Sur. Recovery (ELCD)	Surrogate Recovery on the Electrolytic Conductivity Detector.
Sur. Recovery (PID)	Surrogate Recovery on the Photoionization Detector.
Standard Measured	Amount measured for a laboratory control sample
Standard Amt Added	Known value for a laboratory control sample
Standard % Recovery	% recovered for a laboratory control sample with a known value.
Lab Fort Blank Amt	Laboratory Fortified Blank Amount Added
Lab Fort Blk. Found	Laboratory Fortified Blank Amount Found
Lab Fort Blk % Rec	Laboratory Fortified Blank % Recovered
Dup Lab Fort Bl Amt	Duplicate Laboratory Fortified Blank Amount Added
Dup Lab Fort Bl Fnd	Duplicate Laboratory Fortified Blank Amount Found
Dup Lab Fort Bl % Rec	Duplicate Laboratory Fortified Blank % Recovery
Lab Fort Blank Range	Laboratory Fortified Blank Range (Absolute value of difference between recoveries for Lab Fortified Blank and Lab Fortified Blank Duplicate).
Lab Fort Bl. Av. Rec.	Laboratory Fortified Blank Average Recovery
Duplicate Sample Amt	Sample Value for Duplicate used with Matrix Spike Duplicate
MSD Amount Added	Matrix Spike Duplicate Amount Added (Spiked)
MSD Amt Measured	Matrix Spike Duplicate Amount Measured
MSD % Recovery	Matrix Spike Duplicate % Recovery
MSD Range	Absolute difference between Matrix Spike and Matrix Spike Duplicate Recoveries



con-test
ANALYTICAL LABORATORY

Phone: 413-525-2332
Fax: 413-525-6405
Email: info@contestlabs.com
www.contestlabs.com

CHAIN OF CUSTODY RECORD

39 SPRUCE ST
EAST LONGMEADOW, MA 01028

Company Name: IFM
Address: 300 Metro Center Blvd
Wrentham, RI 02896

Telephone: (401) 738-3007
Project # 081-12157-02
Client PO # _____

Attention: Donna Palistov

DATA DELIVERY (check one):
 FAX EMAIL WEBSITE CLIENT

Project Location: Springfield St. School, Prov. RI

Fax #: _____
Email: Donna.palistov@ifm.com

Sampled By: AKL

Format: EXCEL PDF GIS KEY

Proposal Provided? (For Billing purposes)
 yes no

State Form Required?
 yes no

Field ID	Sample Description	Lab #	Date Sampled		Comp- osite	Grab	*Matrix Code	ANALYSIS REQUESTED	# of containers
			Start Date/Time	Stop Date/Time					

VOCS (2260)

**Preservation Codes:
~Cont. Code: _____
A=amber glass
G=glass
P=plastic
ST=sterile
V=vial
S=summary can
T=tedlar bag
O=Other

**Matrix Code: _____
GW= groundwater
WW= wastewater
DW= drinking water
A= air
S= soil/solid
SL= sludge
O= other

**Preservation Codes:
I= ice
H= HCL
M= Methanol
N= Nitric Acid
S= Sulfuric Acid
B= Sodium bisulfate
O= Other

*Turnaround time begins at 9:00 a.m. the day after sample receipt (unless received before 2:00 p.m.)
*Require lab approval

Client Comments: _____

Laboratory Comments:

Relinquished by: (signature) _____ Date/Time: 2/21/06

Received by: (signature) _____ Date/Time: 2/21/06 1110

Relinquished by: (signature) _____ Date/Time: 2/6/06 1515

Received by: (signature) _____ Date/Time: 2/6/06 1515

Turnaround **
 7-Day
 10-Day
 Other 5 days
RUSH *

Detection Limit Requirements
Regulations? RI 08

Data Enhancement Project/RCP? Y N

Special Requirements or DL's: _____

Con-Test Laboratory is the ONLY independent laboratory in all of New England with both prestigious ALHA and NELAP Certifications and WBE/DBE Certified!

MPB



www.contestlabs.com

39 Spruce Street
East Longmeadow, MA
Phone: 1-413-525-2332
Fax: 1-413-525-6405

SAMPLE RECEIPT CHECKLIST

CLIENT NAME: LFZ

RECEIVED BY: (Signature) DATE: 2/6/06

- 1. Was chain of custody relinquished and signed? YES NO
- 2. Does Chain agree with samples? YES NO

If not, explain:

- 3. All Samples in good condition? YES NO

If not, explain:

- 4. Were samples received in compliance with Temperature 0-6 degrees C? YES NO

Degrees: 2.0

- 5. Are there any on hold samples? YES NO

- 6. Laboratory analysts notified? YES NO

Who MM Time 3:45 Date 2/6/06

- 7. Location where samples are stored: 1B

CONTAINERS SENT IN TO CON-TEST	# of containers	CONTAINERS SENT TO CON-TEST	# of containers
1 liter amber		Air Cassettes	
500 ml amber		8 oz clear jar	
250 ml amber (8oz. Amber)		4 oz clear jar	
1 liter plastic		2 oz clear jar	
500 ml plastic		Plastic bag	
250 ml plastic		Encore	
40 ml vial	<u>15</u>	Brass Sleeves	
Colisure bottle		Tubes	
Dissolved oxygen bottle		Summa cans	
Flashpoint bottle		Other	

Laboratory comments: * 2 Trip Blanks sent not on Coc

Attachment B
Soil Gas Graphs

Soil Gas Well EPL1
Fluctuation in Methane, Oxygen, and Carbon Dioxide Percentages over Time
Springfield Street School Complex
Providence, Rhode Island

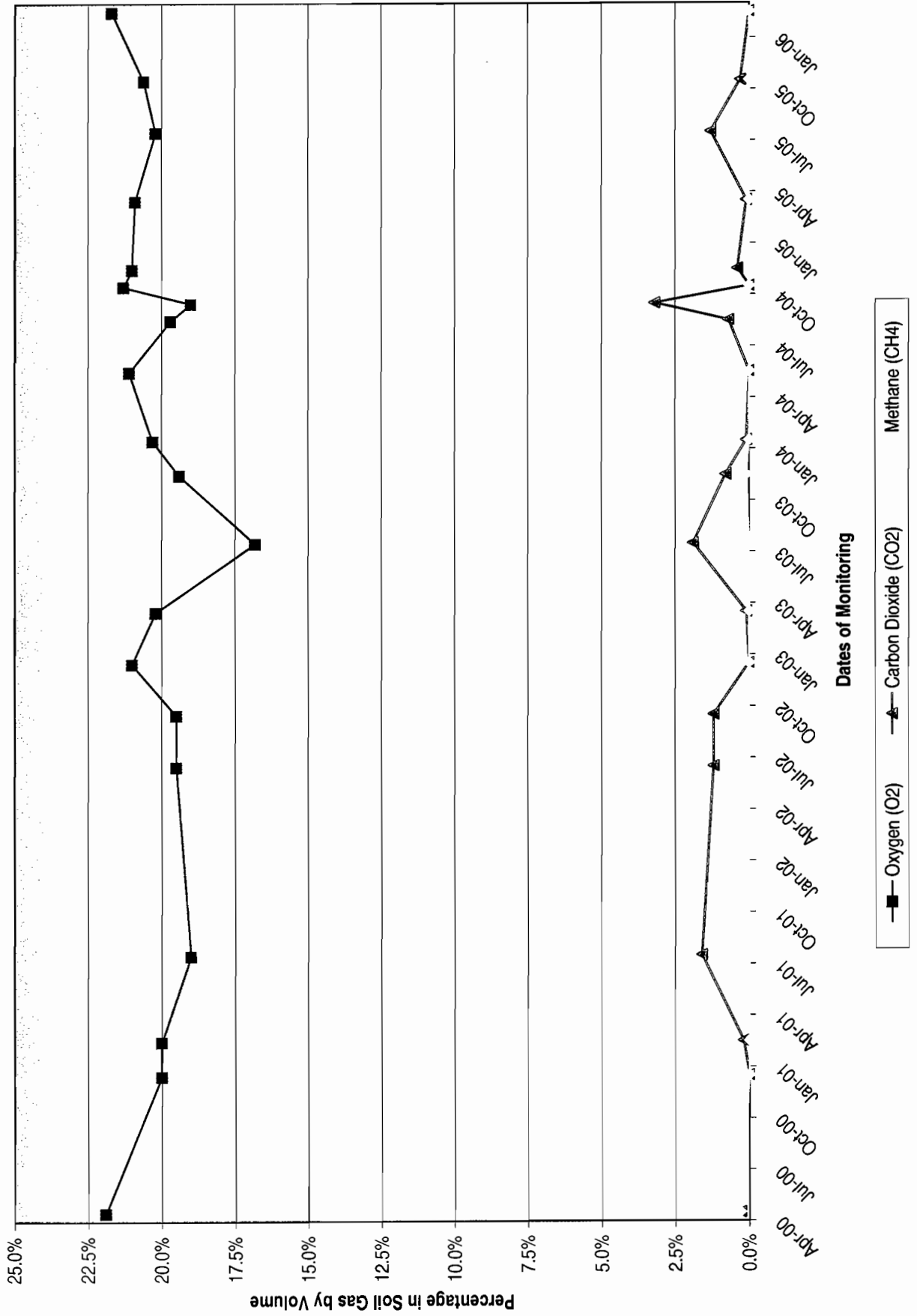

Soil Gas Well EPL4
Fluctuation in Methane, Oxygen, and Carbon Dioxide Percentages over Time
Springfield Street School Complex
Providence, Rhode Island

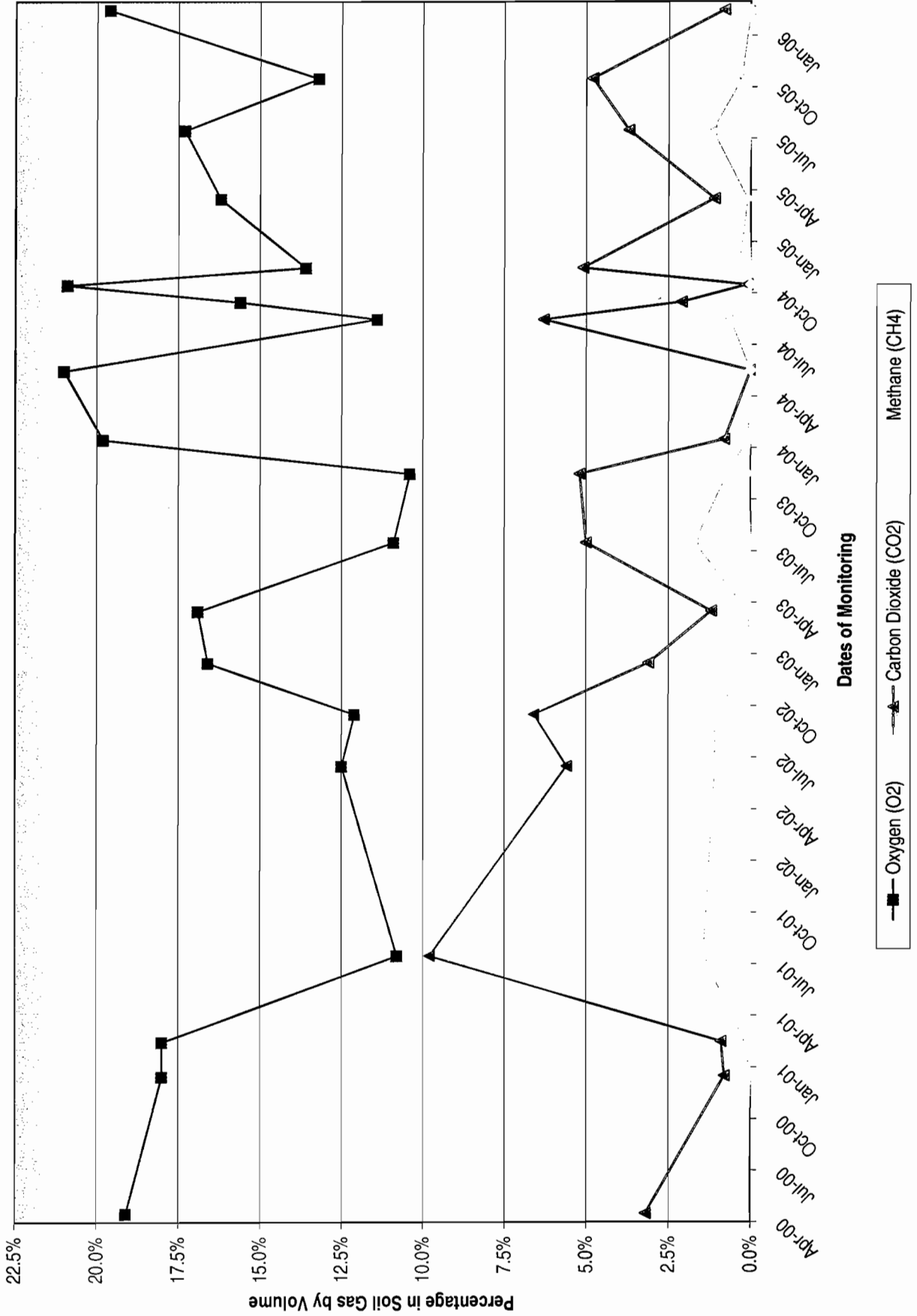

Soil Gas Well MG2
Fluctuation in Methane, Oxygen, and Carbon Dioxide Percentages over Time
Springfield Street School Complex
Providence, Rhode Island

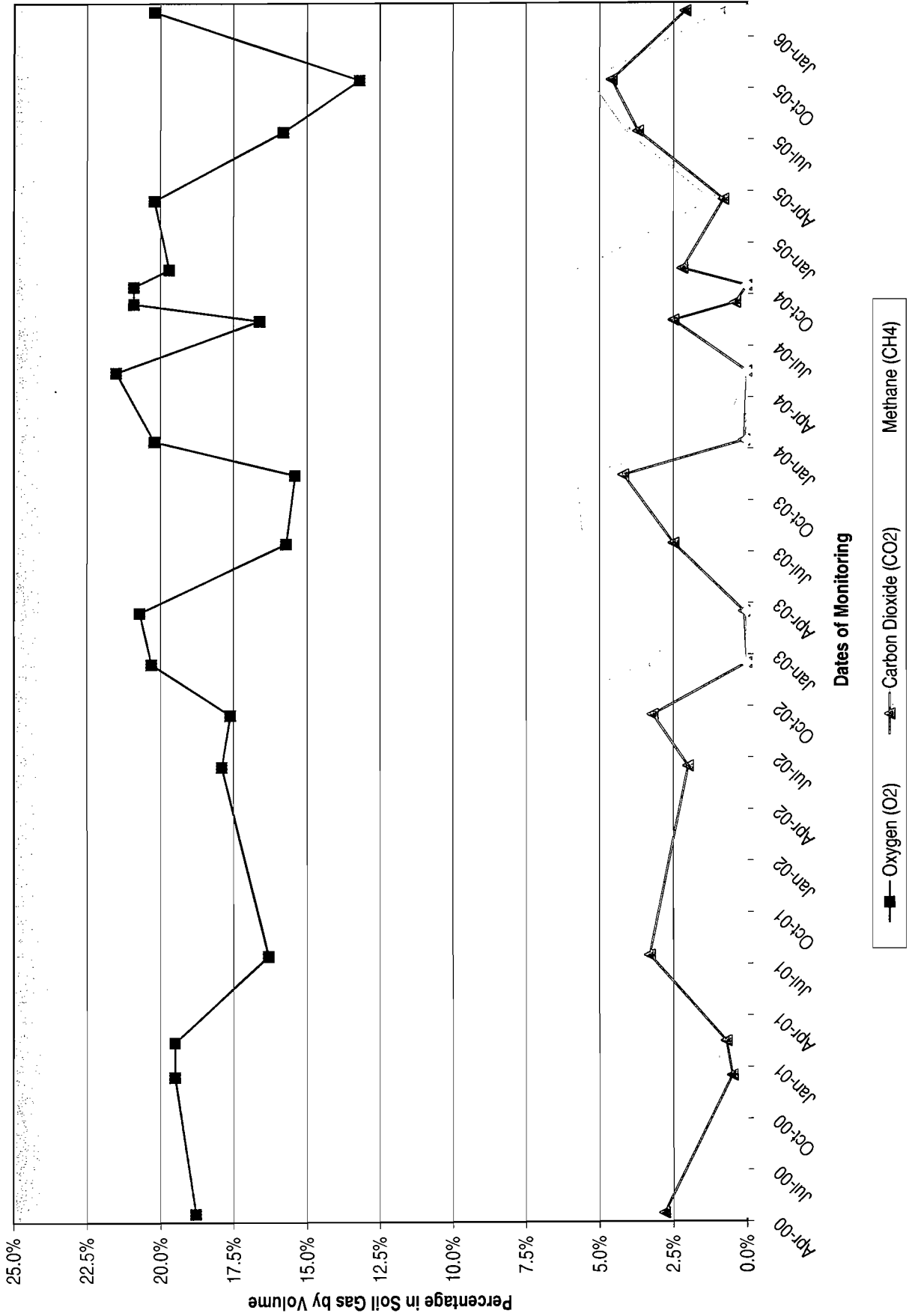

Soil Gas Well MPL5
Fluctuation in Methane, Oxygen, and Carbon Dioxide Percentages over Time
Springfield Street School Complex
Providence, Rhode Island

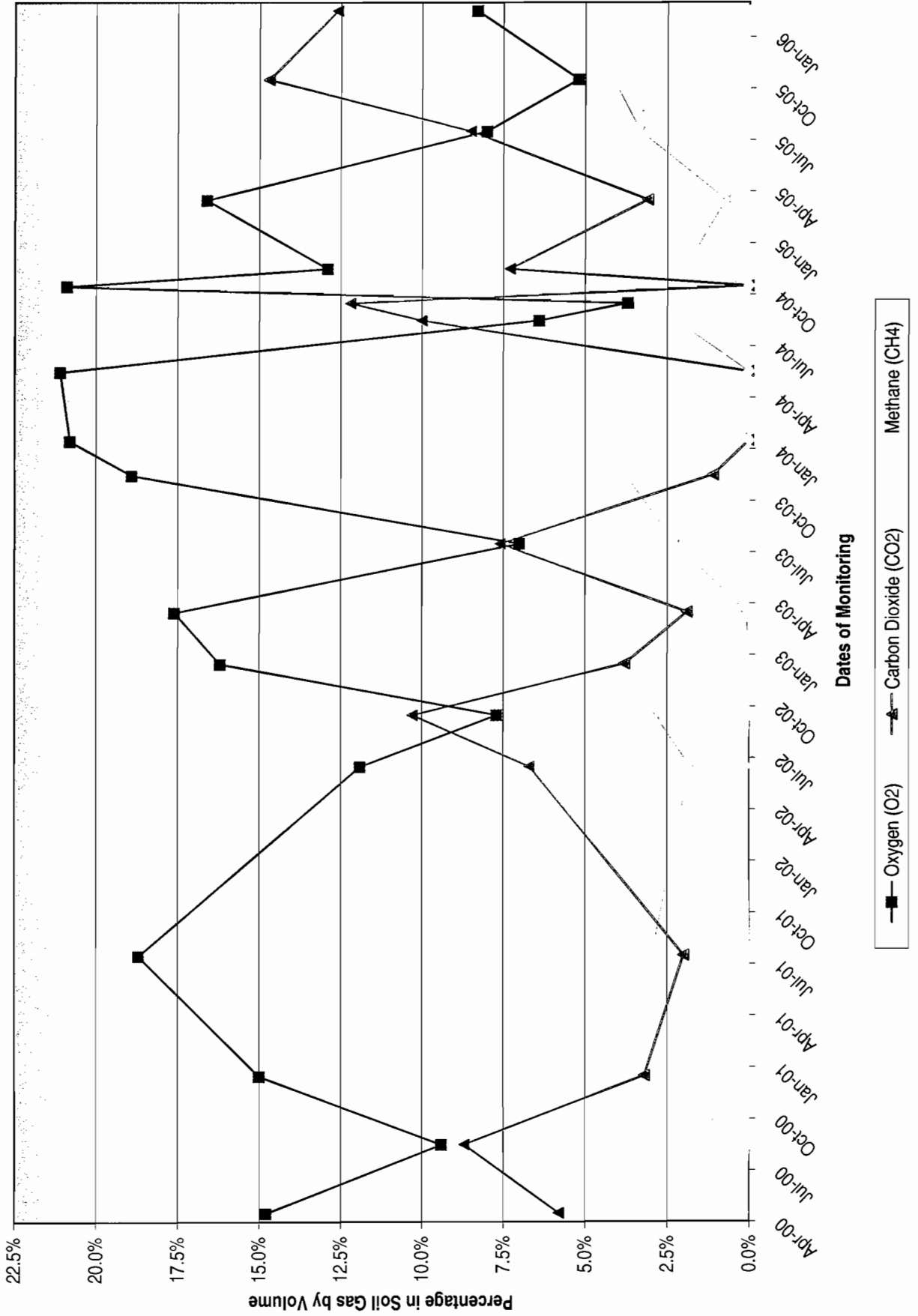

Soil Gas Well WB1
Fluctuation in Methane, Oxygen, and Carbon Dioxide Percentages over Time
Springfield Street School Complex
Providence, Rhode Island

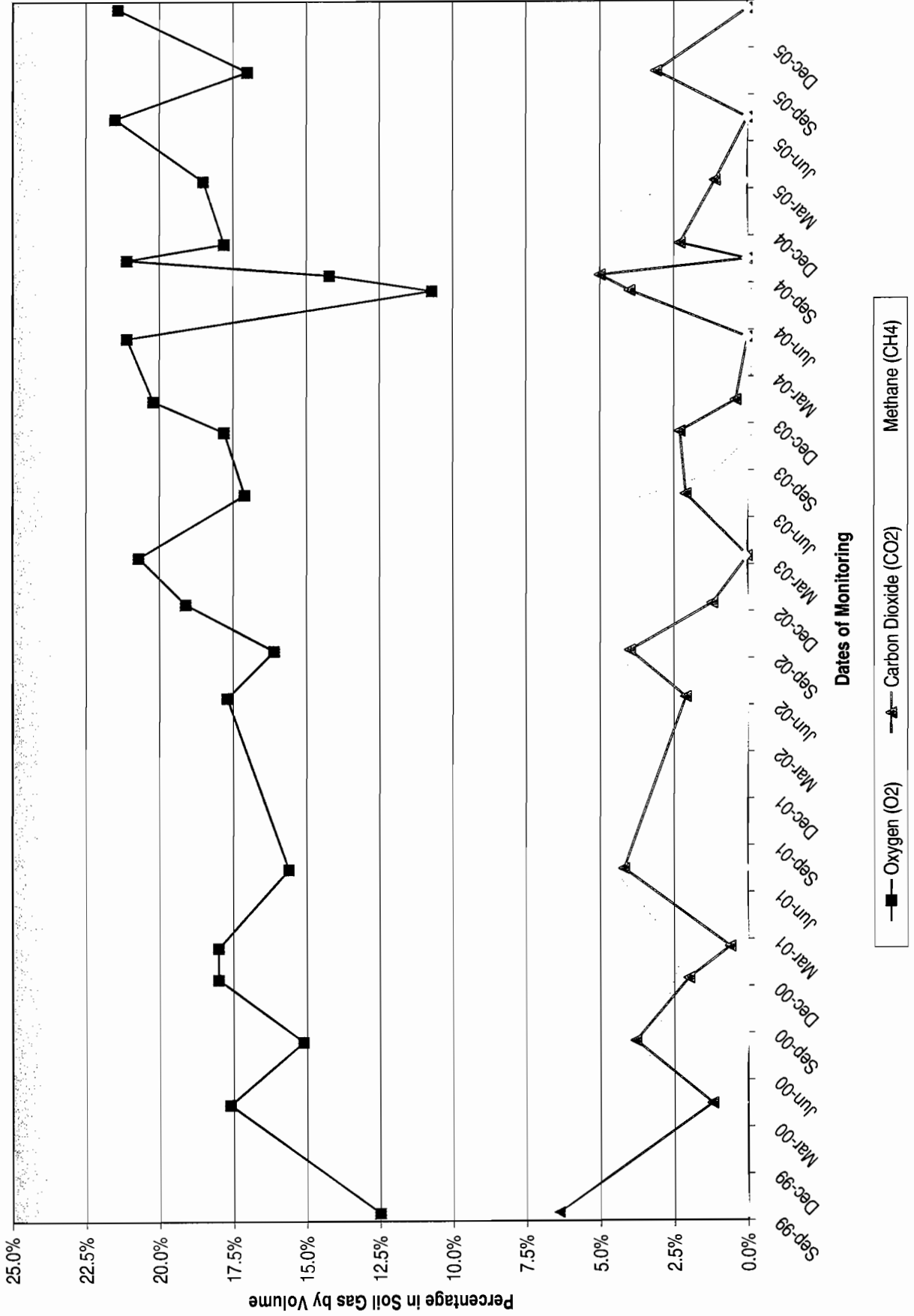

Soil Gas Well WB7
Fluctuation in Methane, Oxygen, and Carbon Dioxide Percentages over Time
Springfield Street School Complex
Providence, Rhode Island

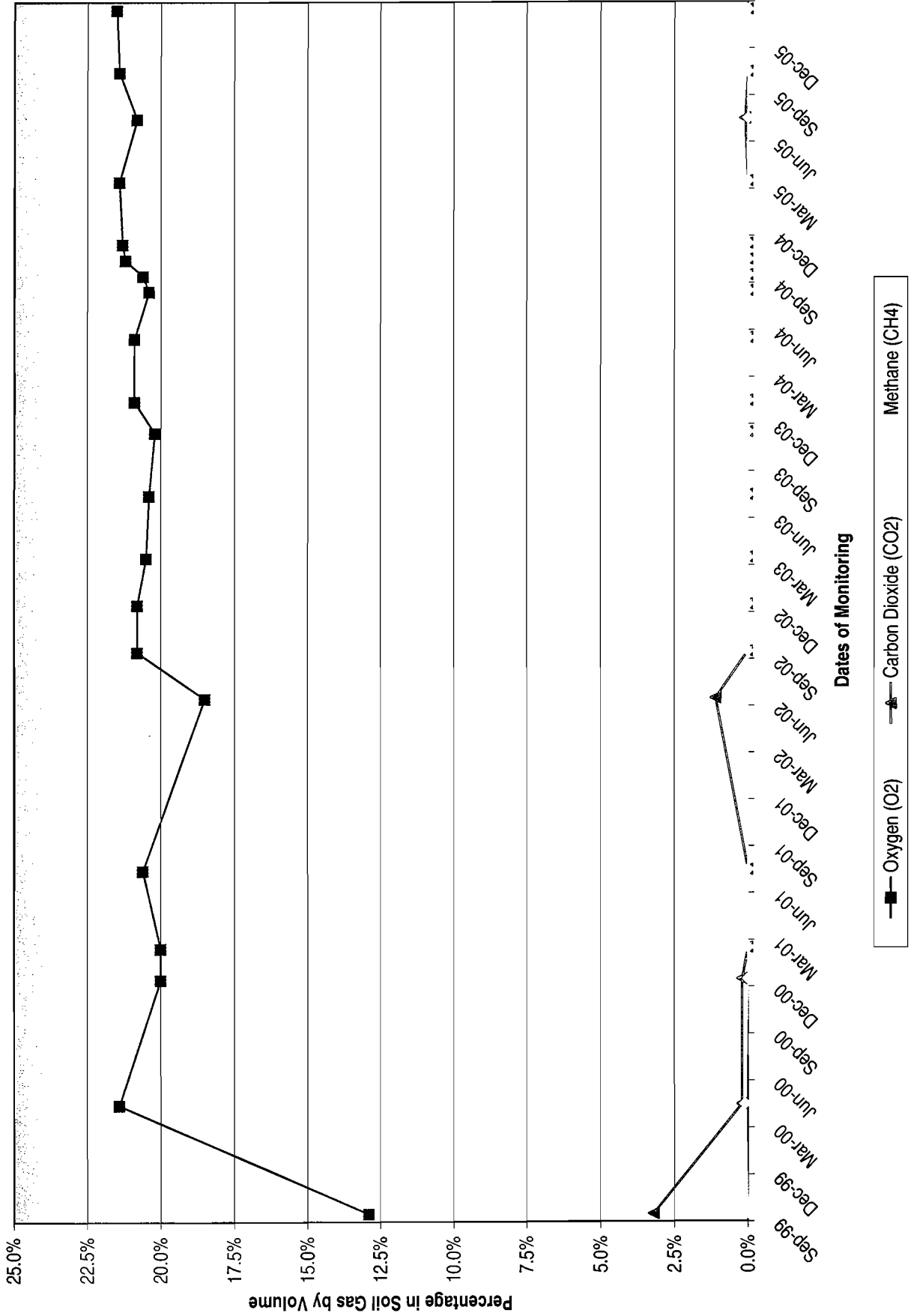

Soil Gas Well WB15
Fluctuation in Methane, Oxygen, and Carbon Dioxide Percentages over Time
Springfield Street School Complex
Providence, Rhode Island

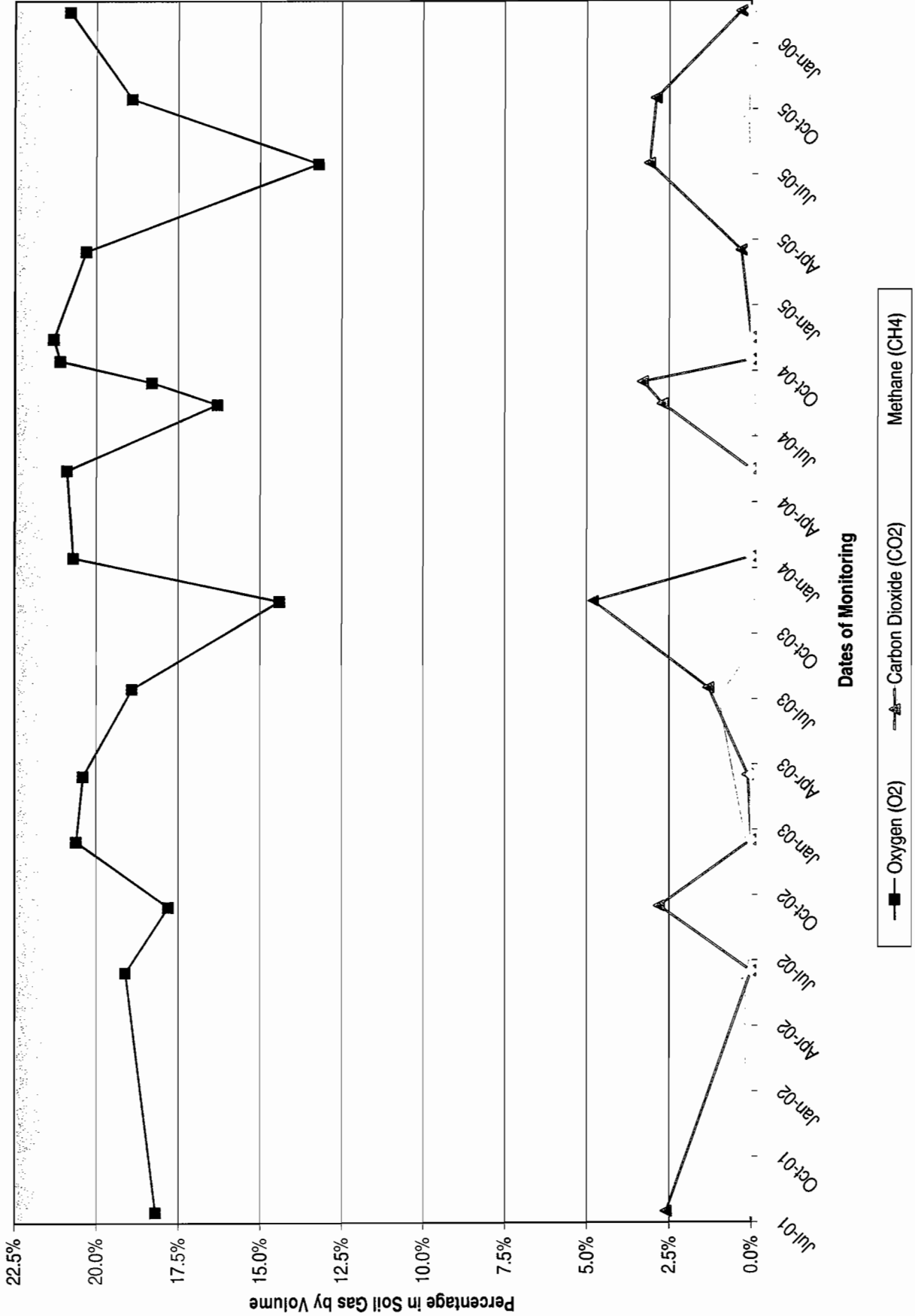

Attachment C

Laboratory Report for Soil Gas



39 Spruce Street ° East Longmeadow, MA 01028 ° FAX 413/525-6405 ° TEL. 413/525-2332

REPORT DATE 2/7/2006

LEVINE FRICKE
350 METRO CENTER BLVD., SUITE 250
WARWICK, RI 02886
ATTN: DONNA PALLISTER

CONTRACT NUMBER:
PURCHASE ORDER NUMBER: 5131

PROJECT NUMBER: 0811215202

ANALYTICAL SUMMARY

LIMS BAT #: LIMS-95131
JOB NUMBER: 0811215202

The results of analyses performed on the following samples submitted to the CON-TEST Analytical Laboratory are found in this report.

PROJECT LOCATION: SPRINGFIELD ST SCHOOL

FIELD SAMPLE #	LAB ID	MATRIX	SAMPLE DESCRIPTION	TEST
MPL-6	06B03953	AIR	NOT SPECIFIED	to-14 ppbv
MPL-6	06B03953	AIR	NOT SPECIFIED	to-14 ug/m3
WB-2	06B03952	AIR	NOT SPECIFIED	to-14 ppbv
WB-2	06B03952	AIR	NOT SPECIFIED	to-14 ug/m3

The CON-TEST Environmental Laboratory operates under the following certifications and accreditations :

AIHA 100033	AIHA ELLAP (LEAD) 100033	
MASSACHUSETTS MA0100	NEW HAMPSHIRE NELAP 2516	NEW JERSEY NELAP NJ MA007 (AIR)
CONNECTICUT PH-0567	VERMONT DOH (LEAD) No. LL015036	ARIZONA AZ0648
NEW YORK ELAP/NELAP 10899	RHODE ISLAND (LIC. No. 112)	ARIZONA AZ0654 (AIR)

I certify that the analyses listed above, unless specifically listed as subcontracted, if any, were performed under my direction according to the approved methodologies listed in this document, and that based upon my inquiry of those individuals immediately responsible for obtaining the information, the material contained in this report is, to the best of my knowledge and belief, accurate and complete.

Edward Denson 2/7/06

Tod Kopyscinski
Director of Operations

Sondra L. Slesinski
Quality Assurance Officer

SIGNATURE

DATE

Edward Denson
Technical Director

DONNA PALLISTER
 LEVINE FRICKE
 350 METRO CENTER BLVD., SUITE 250
 WARWICK, RI 02886

Purchase Order No.: 5131

2/7/2006

Page 1 of 9

Project Location: SPRINGFIELD ST SCHOOL
 Date Received: 2/3/2006
 Field Sample #: MPL-6

Project Number: 0811215202
 LIMS-BAT #: LIMS-95131
 Job Number: 0811215202

Sample ID : 06B03953 Sampled : 2/3/2006
 NOT SPECIFIED

Sample Matrix: AIR

	Units	Results	Date Analyzed	Analyst	RL	SPEC Limit		P / F
						Lo	Hi	
Benzene	PPBv	ND	02/06/06	TPH	0.5			
Bromomethane	PPBv	ND	02/06/06	TPH	0.5			
Carbon Tetrachloride	PPBv	ND	02/06/06	TPH	0.5			
Chlorobenzene	PPBv	ND	02/06/06	TPH	0.5			
Chloroethane	PPBv	ND	02/06/06	TPH	0.5			
Chloroform	PPBv	ND	02/06/06	TPH	0.5			
Chloromethane	PPBv	ND	02/06/06	TPH	0.5			
1,2-Dibromoethane	PPBv	ND	02/06/06	TPH	0.5			
1,2-Dichlorobenzene	PPBv	ND	02/06/06	TPH	0.5			
1,3-Dichlorobenzene	PPBv	ND	02/06/06	TPH	0.5			
1,4-Dichlorobenzene	PPBv	0.7	02/06/06	TPH	0.5			
Dichlorodifluoromethane	PPBv	ND	02/06/06	TPH	0.5			
1,1-Dichloroethane	PPBv	ND	02/06/06	TPH	0.5			
1,2-Dichloroethane	PPBv	ND	02/06/06	TPH	0.5			
1,1-Dichloroethylene	PPBv	ND	02/06/06	TPH	0.5			
cis-1,2-Dichloroethylene	PPBv	ND	02/06/06	TPH	0.5			
1,2-Dichloropropane	PPBv	ND	02/06/06	TPH	0.5			
cis-1,3-Dichloropropene	PPBv	ND	02/06/06	TPH	0.5			
trans-1,3-Dichloropropene	PPBv	ND	02/06/06	TPH	0.5			
1,2-Dichlorotetrafluoroethane (114)	PPBv	ND	02/06/06	TPH	0.5			
Ethylbenzene	PPBv	1.0	02/06/06	TPH	0.5			
Hexachlorobutadiene	PPBv	ND	02/06/06	TPH	0.5			
Methylene Chloride	PPBv	ND	02/06/06	TPH	0.5			
Styrene	PPBv	0.7	02/06/06	TPH	0.5			
1,1,2,2-Tetrachloroethane	PPBv	ND	02/06/06	TPH	0.5			
Tetrachloroethylene	PPBv	ND	02/06/06	TPH	0.5			
Toluene	PPBv	9.2	02/06/06	TPH	0.5			
1,2,4-Trichlorobenzene	PPBv	ND	02/06/06	TPH	0.5			
1,1,1-Trichloroethane	PPBv	ND	02/06/06	TPH	0.5			
1,1,2-Trichloroethane	PPBv	ND	02/06/06	TPH	0.5			

RL = Reporting Limit

ND = Not Detected at or above the Reporting Limit

NM = Not Measured

SPEC LIMIT = a client specified recommended or regulatory level for comparison with data to determine PASS (P) or FAIL (F) condition of results.

* = See end of report for comments and notes applying to this sample

DONNA PALLISTER
 LEVINE FRICKE
 350 METRO CENTER BLVD., SUITE 250
 WARWICK, RI 02886

Purchase Order No.: 5131

2/7/2006
 Page 2 of 9

Project Number: 0811215202
 LIMS-BAT #: LIMS-95131
 Job Number: 0811215202

Project Location: SPRINGFIELD ST SCHOOL
 Date Received: 2/3/2006
 Field Sample #: MPL-6

Sample ID : 06B03953 Sampled : 2/3/2006
 NOT SPECIFIED

Sample Matrix: AIR

	Units	Results	Date Analyzed	Analyst	RL	SPEC Limit		P/ F
						Lo	Hi	
Trichloroethylene	PPBv	ND	02/06/06	TPH	0.5			
Trichlorofluoromethane (Freon 11)	PPBv	ND	02/06/06	TPH	0.5			
1,1,2-Trichloro-1,2,2-Trifluoroethane	PPBv	ND	02/06/06	TPH	0.5			
1,2,4-Trimethylbenzene	PPBv	ND	02/06/06	TPH	0.5			
1,3,5-Trimethylbenzene	PPBv	ND	02/06/06	TPH	0.5			
Vinyl Chloride	PPBv	ND	02/06/06	TPH	0.5			
m/p-Xylene	PPBv	3.3	02/06/06	TPH	1.0			
o-Xylene	PPBv	1.3	02/06/06	TPH	0.5			

Analytical Method:
 EPA TO-14A

SAMPLES ARE TAKEN IN SUMMA CANISTERS AND ANALYZED BY GAS CHROMATOGRAPHY WITH MASS SPECTROMETRY DETECTION. (GC/MS)

RL = Reporting Limit

ND = Not Detected at or above the Reporting Limit

NM = Not Measured

SPEC LIMIT = a client specified recommended or regulatory level for comparison with data to determine PASS (P) or FAIL (F) condition of results.

* = See end of report for comments and notes applying to this sample

DONNA PALLISTER
 LEVINE FRICKE
 350 METRO CENTER BLVD., SUITE 250
 WARWICK, RI 02886

Purchase Order No.: 5131

2/7/2006
 Page 3 of 9

Project Location: SPRINGFIELD ST SCHOOL
 Date Received: 2/3/2006

Project Number: 0811215202
 LIMS-BAT #: LIMS-95131
 Job Number: 0811215202

Field Sample #: WB-2

Sample ID: 06B03952 Sampled: 2/3/2006
 NOT SPECIFIED

Sample Matrix: AIR

	Units	Results	Date Analyzed	Analyst	RL	SPEC Limit		P / F
						Lo	Hi	
Benzene	PPBv	ND	02/04/06	TPH	0.5			
Bromomethane	PPBv	ND	02/04/06	TPH	0.5			
Carbon Tetrachloride	PPBv	ND	02/04/06	TPH	0.5			
Chlorobenzene	PPBv	ND	02/04/06	TPH	0.5			
Chloroethane	PPBv	ND	02/04/06	TPH	0.5			
Chloroform	PPBv	ND	02/04/06	TPH	0.5			
Chloromethane	PPBv	ND	02/04/06	TPH	0.5			
1,2-Dibromoethane	PPBv	ND	02/04/06	TPH	0.5			
1,2-Dichlorobenzene	PPBv	ND	02/04/06	TPH	0.5			
1,3-Dichlorobenzene	PPBv	ND	02/04/06	TPH	0.5			
1,4-Dichlorobenzene	PPBv	0.8	02/04/06	TPH	0.5			
Dichlorodifluoromethane	PPBv	ND	02/04/06	TPH	0.5			
1,1-Dichloroethane	PPBv	ND	02/04/06	TPH	0.5			
1,2-Dichloroethane	PPBv	ND	02/04/06	TPH	0.5			
1,1-Dichloroethylene	PPBv	ND	02/04/06	TPH	0.5			
cis-1,2-Dichloroethylene	PPBv	ND	02/04/06	TPH	0.5			
1,2-Dichloropropane	PPBv	ND	02/04/06	TPH	0.5			
cis-1,3-Dichloropropene	PPBv	ND	02/04/06	TPH	0.5			
trans-1,3-Dichloropropene	PPBv	ND	02/04/06	TPH	0.5			
1,2-Dichlorotetrafluoroethane (114)	PPBv	ND	02/04/06	TPH	0.5			
Ethylbenzene	PPBv	0.9	02/04/06	TPH	0.5			
Hexachlorobutadiene	PPBv	ND	02/04/06	TPH	0.5			
Methylene Chloride	PPBv	1.0	02/04/06	TPH	0.5			
Styrene	PPBv	0.9	02/04/06	TPH	0.5			
1,1,2,2-Tetrachloroethane	PPBv	ND	02/04/06	TPH	0.5			
Tetrachloroethylene	PPBv	ND	02/04/06	TPH	0.5			
Toluene	PPBv	8.7	02/04/06	TPH	0.5			
1,2,4-Trichlorobenzene	PPBv	ND	02/04/06	TPH	0.5			
1,1,1-Trichloroethane	PPBv	ND	02/04/06	TPH	0.5			
1,1,2-Trichloroethane	PPBv	ND	02/04/06	TPH	0.5			

RL = Reporting Limit

SPEC LIMIT = a client specified recommended or regulatory level for comparison with data to determine PASS (P) or FAIL (F) condition of results.

ND = Not Detected at or above the Reporting Limit

NM = Not Measured

* = See end of report for comments and notes applying to this sample

DONNA PALLISTER
 LEVINE FRICKE
 350 METRO CENTER BLVD., SUITE 250
 WARWICK, RI 02886

Purchase Order No.: 5131

2/7/2006

Page 4 of 9

Project Location: SPRINGFIELD ST SCHOOL

Project Number: 0811215202

Date Received: 2/3/2006

LIMS-BAT #: LIMS-95131

Field Sample #: WB-2

Job Number: 0811215202

Sample ID : 06B03952

Sampled : 2/3/2006

NOT SPECIFIED

Sample Matrix: AIR

	Units	Results	Date Analyzed	Analyst	RL	SPEC Limit		P/ F
						Lo	Hi	
Trichloroethylene	PPBv	ND	02/04/06	TPH	0.5			
Trichlorofluoromethane (Freon 11)	PPBv	ND	02/04/06	TPH	0.5			
1,1,2-Trichloro-1,2,2-Trifluoroethane	PPBv	ND	02/04/06	TPH	0.5			
1,2,4-Trimethylbenzene	PPBv	ND	02/04/06	TPH	0.5			
1,3,5-Trimethylbenzene	PPBv	ND	02/04/06	TPH	0.5			
Vinyl Chloride	PPBv	ND	02/04/06	TPH	0.5			
m/p-Xylene	PPBv	3.0	02/04/06	TPH	1.0			
o-Xylene	PPBv	1.2	02/04/06	TPH	0.5			

Analytical Method:

EPA TO-14A

SAMPLES ARE TAKEN IN SUMMA CANISTERS AND ANALYZED BY GAS CHROMATOGRAPHY WITH MASS SPECTROMETRY DETECTION. (GC/MS)

RL = Reporting Limit

ND = Not Detected at or above the Reporting Limit

NM = Not Measured

* = See end of report for comments and notes applying to this sample

SPEC LIMIT = a client specified recommended or regulatory level for comparison with data to determine PASS (P) or FAIL (F) condition of results.

DONNA PALLISTER
 LEVINE FRICKE
 350 METRO CENTER BLVD., SUITE 250
 WARWICK, RI 02886

Purchase Order No.: 5131

2/7/2006
 Page 5 of 9

Project Location: SPRINGFIELD ST SCHOOL
 Date Received: 2/3/2006
 Field Sample #: MPL-6

Project Number: 0811215202
 LIMS-BAT #: LIMS-95131
 Job Number: 0811215202

Sample ID: *06B03953 Sampled: 2/3/2006
 NOT SPECIFIED

Sample Matrix: AIR

	Units	Results	Date Analyzed	Analyst	RL	SPEC Limit		P/ F
						Lo	Hi	
Benzene	ug/m3	ND	02/06/06	TPH	1.6			
Bromomethane	ug/m3	ND	02/06/06	TPH	1.9			
Carbon Tetrachloride	ug/m3	ND	02/06/06	TPH	3.1			
Chlorobenzene	ug/m3	ND	02/06/06	TPH	2.3			
Chloroethane	ug/m3	ND	02/06/06	TPH	1.3			
Chloroform	ug/m3	ND	02/06/06	TPH	2.4			
Chloromethane	ug/m3	ND	02/06/06	TPH	1.0			
1,2-Dibromoethane	ug/m3	ND	02/06/06	TPH	3.8			
1,2-Dichlorobenzene	ug/m3	ND	02/06/06	TPH	3.0			
1,3-Dichlorobenzene	ug/m3	ND	02/06/06	TPH	3.0			
1,4-Dichlorobenzene	ug/m3	4.2	02/06/06	TPH	3.0			
Dichlorodifluoromethane	ug/m3	ND	02/06/06	TPH	2.5			
1,1-Dichloroethane	ug/m3	ND	02/06/06	TPH	2.0			
1,2-Dichloroethane	ug/m3	ND	02/06/06	TPH	2.0			
1,1-Dichloroethylene	ug/m3	ND	02/06/06	TPH	2.0			
cis-1,2-Dichloroethylene	ug/m3	ND	02/06/06	TPH	2.0			
1,2-Dichloropropane	ug/m3	ND	02/06/06	TPH	2.3			
cis-1,3-Dichloropropene	ug/m3	ND	02/06/06	TPH	2.3			
trans-1,3-Dichloropropene	ug/m3	ND	02/06/06	TPH	2.3			
1,2-Dichlorotetrafluoroethane (114)	ug/m3	ND	02/06/06	TPH	3.5			
Ethylbenzene	ug/m3	4.3	02/06/06	TPH	2.2			
Hexachlorobutadiene	ug/m3	ND	02/06/06	TPH	5.3			
Methylene Chloride	ug/m3	ND	02/06/06	TPH	1.7			
Styrene	ug/m3	3.1	02/06/06	TPH	2.1			
1,1,2,2-Tetrachloroethane	ug/m3	ND	02/06/06	TPH	3.4			
Tetrachloroethylene	ug/m3	ND	02/06/06	TPH	3.4			
Toluene	ug/m3	35.	02/06/06	TPH	1.9			
1,2,4-Trichlorobenzene	ug/m3	ND	02/06/06	TPH	3.7			
1,1,1-Trichloroethane	ug/m3	ND	02/06/06	TPH	2.7			
1,1,2-Trichloroethane	ug/m3	ND	02/06/06	TPH	2.7			

RL = Reporting Limit

ND = Not Detected at or above the Reporting Limit

NM = Not Measured

SPEC LIMIT = a client specified recommended or regulatory level for comparison with data to determine PASS (P) or FAIL (F) condition of results.

* = See end of report for comments and notes applying to this sample

DONNA PALLISTER
 LEVINE FRICKE
 350 METRO CENTER BLVD., SUITE 250
 WARWICK, RI 02886

Purchase Order No.: 5131

2/7/2006
 Page 6 of 9

Project Location: SPRINGFIELD ST SCHOOL
 Date Received: 2/3/2006
 Field Sample #: MPL-6

Project Number: 0811215202
 LIMS-BAT #: LIMS-95131
 Job Number: 0811215202

Sample ID : *06B03953 Sampled : 2/3/2006
 NOT SPECIFIED

Sample Matrix: AIR

	Units	Results	Date Analyzed	Analyst	RL	SPEC Limit		P/ F
						Lo	Hi	
Trichloroethylene	ug/m3	ND	02/06/06	TPH	2.7			
Trichlorofluoromethane	ug/m3	ND	02/06/06	TPH	2.8			
1,1,2-Trichloro-1,2,2-Trifluoroethane	ug/m3	ND	02/06/06	TPH	3.8			
1,2,4-Trimethylbenzene	ug/m3	ND	02/06/06	TPH	2.5			
1,3,5-Trimethylbenzene	ug/m3	ND	02/06/06	TPH	2.5			
Vinyl Chloride	ug/m3	ND	02/06/06	TPH	1.3			
m/p-Xylene	ug/m3	14.	02/06/06	TPH	4.3			
o-Xylene	ug/m3	5.6	02/06/06	TPH	2.2			

Analytical Method:
 EPA TO-14A

SAMPLES ARE TAKEN IN SUMMA CANISTERS AND ANALYZED BY GAS CHROMATOGRAPHY WITH MASS SPECTROMETRY DETECTION. (GC/MS)

RL = Reporting Limit

ND = Not Detected at or above the Reporting Limit

NM = Not Measured

SPEC LIMIT = a client specified recommended or regulatory level for comparison with data to determine PASS (P) or FAIL (F) condition of results.

* = See end of report for comments and notes applying to this sample

DONNA PALLISTER
 LEVINE FRICKE
 350 METRO CENTER BLVD., SUITE 250
 WARWICK, RI 02886

Purchase Order No.: 5131

2/7/2006

Page 7 of 9

Project Location: SPRINGFIELD ST SCHOOL
 Date Received: 2/3/2006
 Field Sample #: WB-2

Project Number: 0811215202
 LIMS-BAT #: LIMS-95131
 Job Number: 0811215202

Sample ID : 06B03952 Sampled : 2/3/2006
 NOT SPECIFIED

Sample Matrix: AIR

	Units	Results	Date Analyzed	Analyst	RL	SPEC Limit		P/ F
						Lo	Hi	
Benzene	ug/m3	ND	02/04/06	TPH	1.6			
Bromomethane	ug/m3	ND	02/04/06	TPH	1.9			
Carbon Tetrachloride	ug/m3	ND	02/04/06	TPH	3.1			
Chlorobenzene	ug/m3	ND	02/04/06	TPH	2.3			
Chloroethane	ug/m3	ND	02/04/06	TPH	1.3			
Chloroform	ug/m3	ND	02/04/06	TPH	2.4			
Chloromethane	ug/m3	ND	02/04/06	TPH	1.0			
1,2-Dibromoethane	ug/m3	ND	02/04/06	TPH	3.8			
1,2-Dichlorobenzene	ug/m3	ND	02/04/06	TPH	3.0			
1,3-Dichlorobenzene	ug/m3	ND	02/04/06	TPH	3.0			
1,4-Dichlorobenzene	ug/m3	5.0	02/04/06	TPH	3.0			
Dichlorodifluoromethane	ug/m3	ND	02/04/06	TPH	2.5			
1,1-Dichloroethane	ug/m3	ND	02/04/06	TPH	2.0			
1,2-Dichloroethane	ug/m3	ND	02/04/06	TPH	2.0			
1,1-Dichloroethylene	ug/m3	ND	02/04/06	TPH	2.0			
cis-1,2-Dichloroethylene	ug/m3	ND	02/04/06	TPH	2.0			
1,2-Dichloropropane	ug/m3	ND	02/04/06	TPH	2.3			
cis-1,3-Dichloropropene	ug/m3	ND	02/04/06	TPH	2.3			
trans-1,3-Dichloropropene	ug/m3	ND	02/04/06	TPH	2.3			
1,2-Dichlorotetrafluoroethane (114)	ug/m3	ND	02/04/06	TPH	3.5			
Ethylbenzene	ug/m3	3.9	02/04/06	TPH	2.2			
Hexachlorobutadiene	ug/m3	ND	02/04/06	TPH	5.3			
Methylene Chloride	ug/m3	3.6	02/04/06	TPH	1.7			
Styrene	ug/m3	3.8	02/04/06	TPH	2.1			
1,1,2,2-Tetrachloroethane	ug/m3	ND	02/04/06	TPH	3.4			
Tetrachloroethylene	ug/m3	ND	02/04/06	TPH	3.4			
Toluene	ug/m3	33.	02/04/06	TPH	1.9			
1,2,4-Trichlorobenzene	ug/m3	ND	02/04/06	TPH	3.7			
1,1,1-Trichloroethane	ug/m3	ND	02/04/06	TPH	2.7			
1,1,2-Trichloroethane	ug/m3	ND	02/04/06	TPH	2.7			

RL = Reporting Limit

ND = Not Detected at or above the Reporting Limit

NM = Not Measured

SPEC LIMIT = a client specified recommended or regulatory level for comparison with data to determine PASS (P) or FAIL (F) condition of results.

* = See end of report for comments and notes applying to this sample

DONNA PALLISTER
 LEVINE FRICKE
 350 METRO CENTER BLVD., SUITE 250
 WARWICK, RI 02886

Purchase Order No.: 5131

2/7/2006
 Page 8 of 9

Project Location: SPRINGFIELD ST SCHOOL
 Date Received: 2/3/2006
 Field Sample #: WB-2

Project Number: 0811215202
 LIMS-BAT #: LIMS-95131
 Job Number: 0811215202

Sample ID : 06B03952 Sampled : 2/3/2006
 NOT SPECIFIED

Sample Matrix: AIR

	Units	Results	Date Analyzed	Analyst	RL	SPEC Limit		P/ F
						Lo	Hi	
Trichloroethylene	ug/m3	ND	02/04/06	TPH	2.7			
Trichlorofluoromethane	ug/m3	ND	02/04/06	TPH	2.8			
1,1,2-Trichloro-1,2,2-Trifluoroethane	ug/m3	ND	02/04/06	TPH	3.8			
1,2,4-Trimethylbenzene	ug/m3	ND	02/04/06	TPH	2.5			
1,3,5-Trimethylbenzene	ug/m3	ND	02/04/06	TPH	2.5			
Vinyl Chloride	ug/m3	ND	02/04/06	TPH	1.3			
m/p-Xylene	ug/m3	13.	02/04/06	TPH	4.3			
o-Xylene	ug/m3	5.2	02/04/06	TPH	2.2			

Analytical Method:
 EPA TO-14A

SAMPLES ARE TAKEN IN SUMMA CANISTERS AND ANALYZED BY GAS CHROMATOGRAPHY WITH MASS SPECTROMETRY DETECTION. (GC/MS)

RL = Reporting Limit

ND = Not Detected at or above the Reporting Limit

NM = Not Measured

* = See end of report for comments and notes applying to this sample

SPEC LIMIT = a client specified recommended or regulatory level for comparison with data to determine PASS (P) or FAIL (F) condition of results.

DONNA PALLISTER
LEVINE FRICKE
350 METRO CENTER BLVD., SUITE 250
WARWICK, RI 02886

Purchase Order No.: 5131

2/7/2006

Page 9 of 9

Project Location: SPRINGFIELD ST SCHOOL
Date Received: 2/3/2006

Project Number: 0811215202

LIMS-BAT #: LIMS-95131

Job Number: 0811215202

The following notes were attached to the reported analysis :

Sample ID: * 06B03953

Analysis: 1,2-Dichlorobenzene

LABORATORY FORTIFIED BLANK RECOVERY OUTSIDE OF CONTROL LIMITS. DATA VALIDATION IS NOT AFFECTED SINCE ALL RESULTS ARE "NOT DETECTED" FOR ALL SAMPLES IN THIS BATCH FOR THIS COMPOUND AND BIAS IS ON THE HIGH SIDE.

** END OF REPORT **

RL = Reporting Limit

ND = Not Detected at or above the Reporting Limit

NM = Not Measured

* = See end of report for comments and notes applying to this sample

SPEC LIMIT = a client specified recommended or regulatory level for comparison with data to determine PASS (P) or FAIL (F) condition of results.

QC SUMMARY REPORT

SAMPLE QC: Sample Results with Duplicates

BATCH QC: Lab fortified Blanks and Duplicates

Sample Matrix Spikes and Matrix Spike Duplicates

Standard Reference Materials and Duplicates

Method Blanks

Report Date: 2/7/2006

Lims Bat # : LIMS-95131

Page 1 of 2

QC Batch Number: BATCH-10453

Sample Id	Analysis	QC Analysis	Values	Units	Limits
06B03952	4-Bromofluorobenzene	Surrogate Recovery	96.1	%	70-130
06B03953	4-Bromofluorobenzene	Surrogate Recovery	93.8	%	70-130
BLANK-83989	Benzene	Blank	<1.6	ug/m3	
	Carbon Tetrachloride	Blank	<3.1	ug/m3	
	Chloroform	Blank	<2.4	ug/m3	
	1,2-Dichloroethane	Blank	<2.0	ug/m3	
	1,4-Dichlorobenzene	Blank	<3.0	ug/m3	
	Ethylbenzene	Blank	<2.2	ug/m3	
	Styrene	Blank	<2.1	ug/m3	
	Tetrachloroethylene	Blank	<3.4	ug/m3	
	Toluene	Blank	<1.9	ug/m3	
	1,1,1-Trichloroethane	Blank	<2.7	ug/m3	
	Trichloroethylene	Blank	<2.7	ug/m3	
	1,1,2-Trichloro-1,2,2-Trifluoroethane	Blank	<3.8	ug/m3	
	Trichlorofluoromethane	Blank	<2.8	ug/m3	
	o-Xylene	Blank	<2.2	ug/m3	
	m/p-Xylene	Blank	<4.3	ug/m3	
	1,2-Dichlorobenzene	Blank	<3.0	ug/m3	
	1,3-Dichlorobenzene	Blank	<3.0	ug/m3	
	1,1-Dichloroethane	Blank	<2.0	ug/m3	
	1,1-Dichloroethylene	Blank	<2.0	ug/m3	
	Vinyl Chloride	Blank	<1.3	ug/m3	
	Methylene Chloride	Blank	<1.7	ug/m3	
	Chlorobenzene	Blank	<2.3	ug/m3	
	Chloromethane	Blank	<1.0	ug/m3	
	Bromomethane	Blank	<1.9	ug/m3	
	Chloroethane	Blank	<1.3	ug/m3	
	cis-1,3-Dichloropropene	Blank	<2.3	ug/m3	
	trans-1,3-Dichloropropene	Blank	<2.3	ug/m3	
	1,1,2-Trichloroethane	Blank	<2.7	ug/m3	
	1,1,2,2-Tetrachloroethane	Blank	<3.4	ug/m3	
	Hexachlorobutadiene	Blank	<5.3	ug/m3	
	1,2,4-Trichlorobenzene	Blank	<3.7	ug/m3	
	1,2,4-Trimethylbenzene	Blank	<2.5	ug/m3	
	1,3,5-Trimethylbenzene	Blank	<2.5	ug/m3	
	cis-1,2-Dichloroethylene	Blank	<2.0	ug/m3	
	1,2-Dichloropropane	Blank	<2.3	ug/m3	
	Dichlorodifluoromethane	Blank	<2.5	ug/m3	
	1,2-Dibromoethane	Blank	<3.8	ug/m3	
	1,2-Dichlorotetrafluoroethane (114)	Blank	<3.5	ug/m3	

QC SUMMARY REPORT

SAMPLE QC: Sample Results with Duplicates
Sample Matrix Spikes and Matrix Spike Duplicates

BATCH QC: Lab fortified Blanks and Duplicates
Standard Reference Materials and Duplicates
Method Blanks

Report Date: 2/7/2006

Lims Bat #: LIMS-95131

Page 2 of 2

QUALITY CONTROL DEFINITIONS AND ABBREVIATIONS

QC BATCH NUMBER	This is the number assigned to all samples analyzed together that would be subject to comparison with a particular set of Quality Control Data.
LIMITS	Upper and Lower Control Limits for the QC ANALYSIS Reported. All values normally would fall within these statistically determined limits, unless there is an unusual circumstance that would be documented in a NOTE appearing on the last page of the QC SUMMARY REPORT. Not all QC results will have Limits defined.
Sample Amount	Amount of analyte found in a sample.
Blank	Method Blank that has been taken though all the steps of the analysis.
LFBLANK	Laboratory Fortified Blank (a control sample)
STDADD	Standard Added (a laboratory control sample)
Matrix Spk Amt Added	Amount of analyte spiked into a sample
MS Amt Measured	Amount of analyte found including amount that was spiked
Matrix Spike % Rec.	% Recovery of spiked amount in sample.
Duplicate Value	The result from the Duplicate analysis of the sample.
Duplicate RPD	The Relative Percent Difference between two Duplicate Analyses.
Surrogate Recovery	The % Recovery for non-environmental compounds (surrogates) spiked into samples to determine the performance of the analytical methods.
Sur. Recovery (ELCD)	Surrogate Recovery on the Electrolytic Conductivity Detector.
Sur. Recovery (PID)	Surrogate Recovery on the Photoionization Detector.
Standard Measured	Amount measured for a laboratory control sample
Standard Amt Added	Known value for a laboratory control sample
Standard % Recovery	% recovered for a laboratory control sample with a known value.
Lab Fort Blank Amt	Laboratory Fortified Blank Amount Added
Lab Fort Blk. Found	Laboratory Fortified Blank Amount Found
Lab Fort Blk % Rec	Laboratory Fortified Blank % Recovered
Dup Lab Fort Bl Amt	Duplicate Laboratory Fortified Blank Amount Added
Dup Lab Fort Bl Fnd	Duplicate Laboratory Fortified Blank Amount Found
Dup Lab Fort Bl % Rec	Duplicate Laboratory Fortified Blank % Recovery
Lab Fort Blank Range	Laboratory Fortified Blank Range (Absolute value of difference between recoveries for Lab Fortified Blank and Lab Fortified Blank Duplicate).
Lab Fort Bl. Av. Rec.	Laboratory Fortified Blank Average Recovery
Duplicate Sample Amt	Sample Value for Duplicate used with Matrix Spike Duplicate
MSD Amount Added	Matrix Spike Duplicate Amount Added (Spiked)
MSD Amt Measured	Matrix Spike Duplicate Amount Measured
MSD % Recovery	Matrix Spike Duplicate % Recovery
MSD Range	Absolute difference between Matrix Spike and Matrix Spike Duplicate Recoveries

Company Name: LEF Inc.

Address: 300 Metro Center Blvd, #250

Marwick, RI 02886

Attention: Dana Pallister

Project Location: Springfield St School

Sampled By: Janella Bonn

Proposal Provided? (For Billing purposes) yes no

State Form Required? yes no

Telephone: (401) 738-3887
 Project # 081-12152-02
 Client PO # _____

DATA DELIVERY (check one):
 FAX EMAIL WEBSITE CLIENT
 Fax #:
 Email: Dana.Pallister@LEF.com
 Format: EXCEL PDF GIS KEY
 OTHER

Field ID	Sample Description	Lab #	Date Sampled		Comp- osite	Grab	*Matrix Code	ANALYSIS REQUESTED	# of containers
			Start Date/Time	Stop Date/Time					
WB-2	WB-2 2 P th	DB B03952	2/3/06	11:45	✓		A	✓	
MPL-6	MPL-6	DB B03953	2/3/06	12:10	✓		A	✓	

Laboratory Comments:

Relinquished by: (signature) Janella Bonn Date/Time: 12:00 2/3/06

Received by: (signature) Jan MacFarlane Date/Time: 12:10 2/3/06

Relinquished by: (signature) Jan MacFarlane Date/Time: 2:30 2/3/06

Received by: (signature) Janella Bonn Date/Time: 2/3/06 16:00

Turnaround **
 7-Day
 10-Day
 Other: 3 DA RUSH *

Detection Limit Requirements
 Regulations? _____
 Data Enhancement Project/RCP? Y N
 Special Requirements or DL's: _____

*Matrix Code:
 GW = groundwater
 WW = wastewater
 DW = drinking water
 A = air
 S = soil/solid
 SL = sludge
 O = other

**Preservation Codes:
 I = Iced
 H = HCL
 M = Methanol
 N = Nitric Acid
 S = Sulfuric Acid
 B = Sodium bisulfate
 O = Other NONE

X = Na hydroxide
 T = Na thiosulfate

Client Comments:

Con: Code:
 A=amber glass
 G=glass
 P=plastic
 ST=sterile
 V= vial
 S=summa can
 T=ledlar bag
 O=Other

NAB



www.contestlabs.com

59 Spruce Street
East Longmeadow, MA
Phone: 1-413-525-2332
Fax: 1-413-525-6405

SAMPLE RECEIPT CHECKLIST

CLIENT NAME: LPR - R1

RECEIVED BY: NRV

DATE: 2/3/06

1. Was chain of custody relinquished and signed?

YES NO

2. Does Chain agree with samples?

YES NO

If not, explain:

3. All Samples in good condition?

YES NO

If not, explain:

4. Were samples received in compliance with Temperature 0-6 degrees C?

YES NO Degrees: N/A

5. Are there any on hold samples?

YES NO

6. Laboratory analysts notified?

YES NO

Who TPH Time 4:15 Date 2/3/06

7. Location where samples are stored:

CONTAINERS SENT IN TO CON-TEST	# of containers	CONTAINERS SENT TO CON-TEST	# of containers
1 liter amber		Air Cassettes	
500 ml amber		8 oz clear jar	
250 ml amber (8oz. Amber)		4 oz clear jar	
1 liter plastic		2 oz clear jar	
500 ml plastic		Plastic bag <u>Tedlar</u>	<u>2</u>
250 ml plastic		Encore	
40 ml vial		Brass Sleeves	
Colisure bottle		Tubes	
Dissolved oxygen bottle		Summa cans	
Flashpoint bottle		Other	

Laboratory comments: